

# Inductive sensor

## NCB1,5-18GM60-E3-D



- 1.5 mm flush
- Compression proof up to 350 bar, dynamic on active surface
- For applications in hydraulic cylinder



### Dimensions

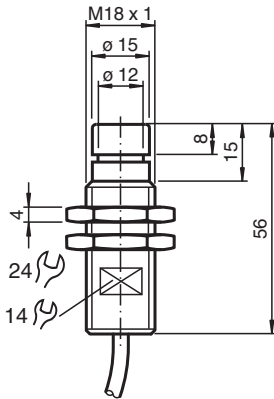

### Technical Data

#### General specifications

Switching function		Normally closed (NC)
Output type		PNP
Rated operating distance	$s_n$	1.5 mm
Installation		flush
Output polarity		DC
Assured operating distance	$s_a$	0 ... 1.22 mm
Reduction factor $r_{304}$		0.5
Output type		3-wire

#### Nominal ratings

Operating voltage	$U_B$	10 ... 60 V
Switching frequency	$f$	0 ... 1500 Hz
Hysteresis	$H$	typ. 5 %
Reverse polarity protection		reverse polarity protected
Short-circuit protection		pulsing
Voltage drop	$U_d$	$\leq 2.5$ V
Operating current	$I_L$	0 ... 200 mA
No-load supply current	$I_0$	$\leq 10$ mA

#### Limit data

Release date: 2024-01-16 Date of issue: 2024-01-16 Filename: 088007\_eng.pdf

Refer to "General Notes Relating to Pepperl+Fuchs Product Information".

Pepperl+Fuchs Group  
www.pepperl-fuchs.com

USA: +1 330 486 0001  
fa-info@us.pepperl-fuchs.com

Germany: +49 621 776 1111  
fa-info@de.pepperl-fuchs.com

Singapore: +65 6779 9091  
fa-info@sg.pepperl-fuchs.com

**PF** PEPPERL+FUCHS

## Technical Data

Operating pressure	350 bar (5076.4 psi)	
<b>Functional safety related parameters</b>		
MTTF <sub>d</sub>	1240 a	
Mission Time (T <sub>M</sub> )	20 a	
Diagnostic Coverage (DC)	0 %	
<b>Compliance with standards and directives</b>		
Standard conformity		
Standards	EN 60947-5-2:2007 EN 60947-5-2/A1:2012 IEC 60947-5-2:2007 IEC 60947-5-2 AMD 1:2012	
<b>Approvals and certificates</b>		
UL approval	cULus Listed, General Purpose	
CCC approval	Certified by China Compulsory Certification (CCC)	
<b>Ambient conditions</b>		
Ambient temperature	-35 ... 80 °C (-31 ... 176 °F)	
<b>Mechanical specifications</b>		
Connection type	cable PVC , 2 m	
Core cross section	0.34 mm <sup>2</sup>	
Housing material	Stainless steel 1.4305 / AISI 303	
Sensing face	Epoxy (black)	
Degree of protection	IP67	
Mass	140 g	
Dimensions		
Length	57 mm	
Diameter	18 mm	

## Connection Assignment

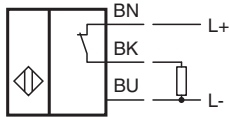

## Installation

### Note

Please refer to the technical information about this product at [www.pepperl-fuchs.com](http://www.pepperl-fuchs.com). This information describes the necessary geometry of the installation space!