

# Inductive sensor

## NJ10-F-E2-10M-Y89586

- Comfort series
- 10 mm non-flush
- 3-wire DC



### Dimensions

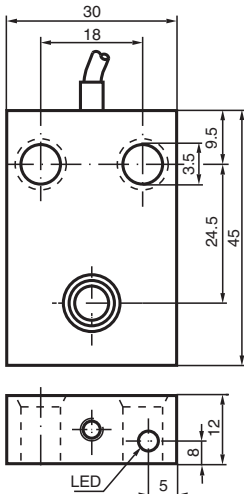

### Technical Data

General specifications			
Rated operating distance	$s_n$		10 mm
Installation			non-flush
Output polarity			DC
Assured operating distance	$s_a$		0 ... 8.1 mm
Actual operating distance	$s_r$		5.4 ... 6.6 mm typ.
Reduction factor $r_{Al}$			0.22
Reduction factor $r_{Cu}$			0.2
Reduction factor $r_{304}$			0.7
Output type			3-wire
Nominal ratings			
Operating voltage	$U_B$		10 ... 60 V DC
Switching frequency	$f$		0 ... 250 Hz
Hysteresis	$H$		0 ... 0.3 typ. 0.1 %
Reverse polarity protection			reverse polarity protected
Short-circuit protection			pulsing
Voltage drop	$U_d$		$\leq 3$ V

Release date: 2023-12-08 Date of issue: 2023-12-08 Filename: 089586\_eng.pdf

Refer to "General Notes Relating to Pepperl+Fuchs Product Information".

Pepperl+Fuchs Group  
www.pepperl-fuchs.com

USA: +1 330 486 0001  
fa-info@us.pepperl-fuchs.com

Germany: +49 621 776 1111  
fa-info@de.pepperl-fuchs.com

Singapore: +65 6779 9091  
fa-info@sg.pepperl-fuchs.com

**PF** PEPPERL+FUCHS

## Technical Data

Operating current	$I_L$	0 ... 200 mA
Off-state current	$I_r$	$\leq 0.5$ mA
No-load supply current	$I_0$	$\leq 20$ mA
Time delay before availability	$t_v$	$\leq 15$ ms
Switching state indicator		LED, yellow
<b>Functional safety related parameters</b>		
MTTF <sub>d</sub>		990 a
Mission Time (T <sub>M</sub> )		20 a
Diagnostic Coverage (DC)		0 %
<b>Compliance with standards and directives</b>		
Standard conformity		
Standards		EN 60947-5-2:2007 IEC 60947-5-2:2007
<b>Approvals and certificates</b>		
UL approval		cULus Listed, General Purpose
CCC approval		Certified by China Compulsory Certification (CCC)
<b>Ambient conditions</b>		
Ambient temperature		-25 ... 70 °C (-13 ... 158 °F)
<b>Mechanical specifications</b>		
Connection type		cable PUR , 10 m
Core cross section		0.34 mm <sup>2</sup>
Housing material		PBT
Sensing face		PBT
Degree of protection		IP67

## Connection

