

# Inductive sensor

## NJ6-22-N-G

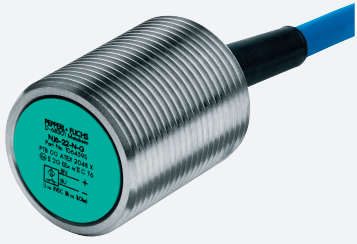

- 6 mm flush
- Usable up to SIL 2 acc. to IEC 61508



### Dimensions

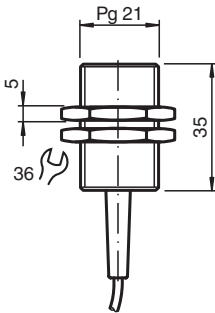

### Technical Data

General specifications			
Switching function			Normally closed (NC)
Output type			NAMUR
Rated operating distance	$s_n$		6 mm
Installation			flush
Assured operating distance	$s_a$		0 ... 4.86 mm
Reduction factor $r_{Al}$			0.4
Reduction factor $r_{Cu}$			0.3
Reduction factor $r_{304}$			0.85
Output type			2-wire
Nominal ratings			
Nominal voltage	$U_o$		8.2 V ( $R_i$ approx. 1 k $\Omega$ )
Switching frequency	$f$		0 ... 2000 Hz
Hysteresis	$H$		typ. %
Current consumption			
Measuring plate not detected			min. 3 mA
Measuring plate detected			$\leq 1$ mA

Release date: 2024-01-09 Date of issue: 2024-01-09 Filename: 70133289\_eng.pdf

Refer to "General Notes Relating to Pepperl+Fuchs Product Information".

Pepperl+Fuchs Group  
www.pepperl-fuchs.com

USA: +1 330 486 0001  
fa-info@us.pepperl-fuchs.com

Germany: +49 621 776 1111  
fa-info@de.pepperl-fuchs.com

Singapore: +65 6779 9091  
fa-info@sg.pepperl-fuchs.com

PEPPERL+FUCHS

## Technical Data

### Functional safety related parameters

Safety Integrity Level (SIL)	SIL 2
MTTF <sub>d</sub>	4566 a
Mission Time (T <sub>M</sub> )	20 a
Diagnostic Coverage (DC)	0 %

### Compliance with standards and directives

Standard conformity	
NAMUR	EN 60947-5-6:2000 IEC 60947-5-6:1999
Standards	EN 60947-5-2:2007 EN 60947-5-2/A1:2012 IEC 60947-5-2:2007 IEC 60947-5-2 AMD 1:2012

### Approvals and certificates

IECEX approval	
Equipment protection level Gb	IECEX PTB 11.0037X
Equipment protection level Da	IECEX PTB 11.0037X
Equipment protection level Dc (tc)	IECEX TUR 21.0018X
Equipment protection level Mb	IECEX PTB 11.0037X
ATEX approval	
Equipment protection level Gb	PTB 00 ATEX 2048 X
Equipment protection level Da	PTB 00 ATEX 2048 X
Equipment protection level Dc (tc)	TÜV 20 ATEX 8524 X
UL approval	cULus Listed, General Purpose
CCC approval	
Hazardous Location	2020322315002255
NEPSI approval	
NEPSI certificate	GYJ16.1393X
CML approval	on request
ANZEx	18.3018X
KCC approval	
Hazardous Location	19-AV4BO-0227

### Ambient conditions

Ambient temperature	-25 ... 100 °C (-13 ... 212 °F)
---------------------	---------------------------------

### Mechanical specifications

Connection type	cable
Housing material	Stainless steel 1.4305 / AISI 303
Sensing face	PBT
Degree of protection	IP68
Cable	
Cable diameter	6 mm ± 0.2 mm
Bending radius	> 10 x cable diameter
Material	PVC
Core cross section	0.75 mm <sup>2</sup>
Length	L 2 m
Dimensions	
Length	35 mm
Diameter	28.3 mm
Thread size	PG21

### General information

Use in the hazardous area	see instruction manuals
---------------------------	-------------------------

Release date: 2024-01-09 Date of issue: 2024-01-09 Filename: 70133289\_eng.pdf

Refer to "General Notes Relating to Pepperl+Fuchs Product Information".

## Connection



Release date: 2024-01-09 Date of issue: 2024-01-09 Filename: 70133289\_eng.pdf

Refer to "General Notes Relating to Pepperl+Fuchs Product Information".

Pepperl+Fuchs Group  
www.pepperl-fuchs.com

USA: +1 330 486 0001  
fa-info@us.pepperl-fuchs.com

Germany: +49 621 776 1111  
fa-info@de.pepperl-fuchs.com

Singapore: +65 6779 9091  
fa-info@sg.pepperl-fuchs.com