

Plastic fiber optic KLR-A32-2,2-2,0-K83



- Wide sensing range

Plastic fiber optic - diffuse

Dimensions

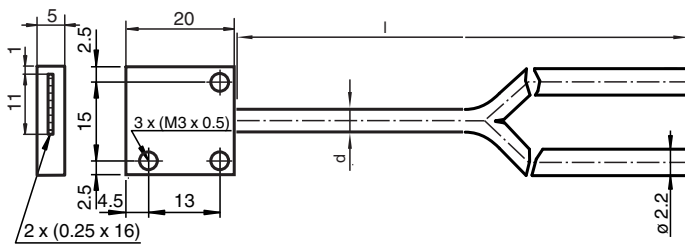

Technical Data

General specifications

Sensor range		SU18: 35 mm SU18/35: 120 mm SU19: 35 mm
Fiber optic length	l	2000 mm , adjustable
Fiber optic diameter	d	2.2 mm
Adapter form		00
End piece		Array
Bending radius		min. 25 mm
Fiber configuration	Fv	see dimensions
Angle of divergence		67 °
Accessories provided		Cutter for plastic fiber optics

Ambient conditions

Ambient temperature		-55 ... 70 °C (-67 ... 158 °F)
---------------------	--	--------------------------------

Mechanical specifications

Material		
Optical face		plastic
Sheathing		PVC

Release date: 2021-07-07 Date of issue: 2021-07-07 Filename: 805837_eng.pdf

Refer to "General Notes Relating to Pepperl+Fuchs Product Information".

Pepperl+Fuchs Group
www.pepperl-fuchs.com

USA: +1 330 486 0001
fa-info@us.pepperl-fuchs.com

Germany: +49 621 776 1111
fa-info@de.pepperl-fuchs.com

Singapore: +65 6779 9091
fa-info@sg.pepperl-fuchs.com

PF PEPPERL+FUCHS

Technical Data

Core	plastic
End piece	brass, nickel-plated
Fiber optic amplifiers	
Device series	SU18 ; SU18/35 ; SU19

Application

Attention:

Fiber optics must not be twisted or kinked. Excessive tensile loads will lead to destruction. Contact with petrol or organic solvents must be prevented.



Release date: 2021-07-07 Date of issue: 2021-07-07 Filename: 805837_eng.pdf

Refer to "General Notes Relating to Pepperl+Fuchs Product Information".

Pepperl+Fuchs Group
www.pepperl-fuchs.com

USA: +1 330 486 0001
fa-info@us.pepperl-fuchs.com

Germany: +49 621 776 1111
fa-info@de.pepperl-fuchs.com

Singapore: +65 6779 9091
fa-info@sg.pepperl-fuchs.com