



Mounting aid

EXG-30

- Clamp for threaded pipe
- Suitable for M30 sensors
- Simple and quick exchange without readjustment
- 2 slotted nuts included with delivery

Quick mounting bracket with dead stop

Dimensions

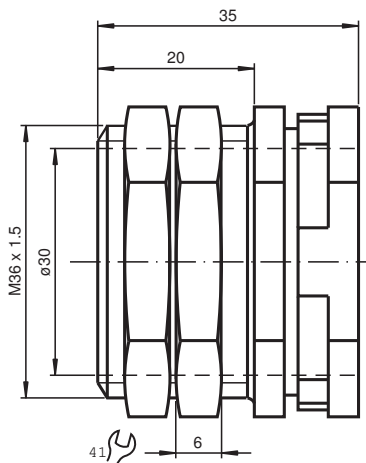

Technical Data

General specifications

Inside diameter 30 mm

Mechanical specifications

Material brass, nickel-plated

Dimensions M36 x 1.5 external thread