

VAZ-BUZZER/LT-RD

EN 50295: 1999

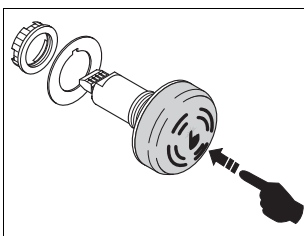

310.450.004.0309

© D

PF PEPPERL+FUCHS
SENSING YOUR NEEDS

Pepperl+Fuchs GmbH
68307 Mannheim · Germany
Telephone: +49 621 776-0
Telefax: +49 621 776-1000
info@de.pepperl-fuchs.com

310_450_004_09-03.fm 5.5.09 www.pepperl-fuchs.com



- Ⓧ Anschluss **ausschließlich** durch ausgebildete Elektro-Fachkräfte.
- Ⓧ Electrical connection is to be made by trained electrical specialists **only**.
- Ⓧ Le branchement doit **uniquement** être effectué par des professionnels.
- Ⓧ Il collegamento deve essere eseguito **solo** da elettricisti specializzati.
- Ⓧ La conexión **sólo** debe ser realizada por electricistas debidamente formados.
- Ⓧ A ligação deve ser feita **exclusivamente** por profissional eléctrico especializado.
- Ⓧ Připojení smí **provádět** pouze kvalifikovaný personál.
- Ⓧ Podłączenie **wyłącznie** przez specjalistów-elektryków.
- Ⓧ Liittäminen kuuluu **ainoastaan** koulutettujen sähköalan ammattilaisten tehtäviin.
- Ⓧ Подключение проводится только специалистами-электриком.
- Ⓧ Bağlantı **sadece** eğitimli elektrik teknisyenleri tarafından yapılmalıdır.
- Ⓧ 布线需由专业电工执行

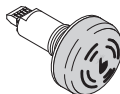
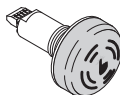

VAZ-BUZZER/ 80 dB (A) / 1m - 2800 Hz
LT-RD I ≤ 80 mA, I₀ < 500 mA

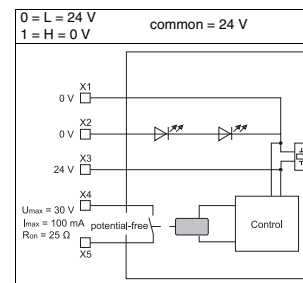
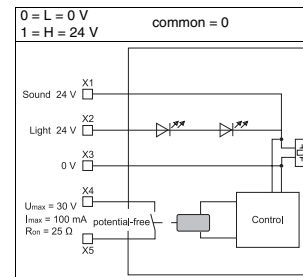
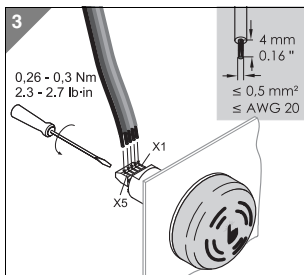
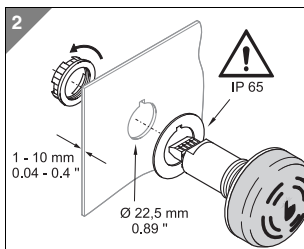
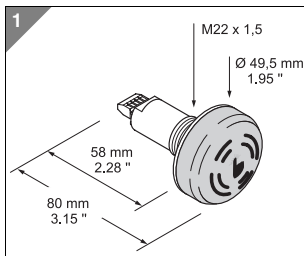

- Ⓧ Betätigungs- und Reaktionszeiten
- Ⓧ Activation and reaction times
- Ⓧ Temps de confirmation et de réaction

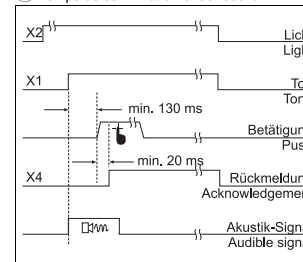



- ① Verdrahtungsbeispiel
- ② Circuit wiring diagram
- ③ Exemple de câblage

