

Overview



Figure 1

These mounting instructions describe how to mount the following parts:

- 1 fitting (provided by the customer)
- 1 MHV-BT-F*-M* adapter plate
- 1 MHV-BT-F* mounting set
- 1 double sensor from the -F25/-F25K/-F31/-F31K2 series
- 1 actuator from the BT32.../BT65... series

Use the respective datasheet specifications to select the correct items. The required screws are included in the scope of delivery of the individual items.

Mounting instructions



i Note

Two screws and two locknuts required for the following step must be provided by the customer due to the customer-specific geometry of the fitting. The diameter of the screws must be 5.5 mm.

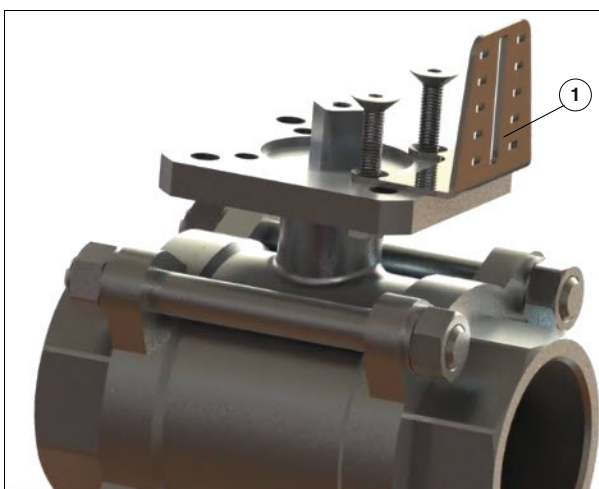

- (1) Position the base (1) of the mounting bridge on the fitting.
- (2) Secure the base (1) to the fitting using two screws that are 5.5 mm in diameter and two locknuts.

i Note

In the following steps, the connection between the square shaft and the adapter plate that is still to be mounted is prepared. The parts are connected using a threaded pin and a drive bolt. Then the threaded pin, locknuts, and drive bolt are screwed in loosely. Only after the adapter plate has been mounted can the threaded pin and the drive bolt be adjusted to the required height and then secured using the locknuts.

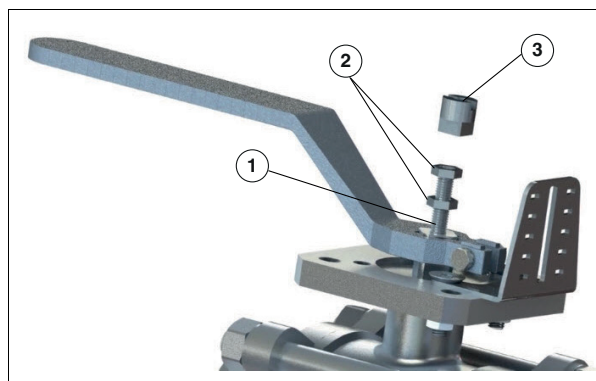

- (3) Screw the threaded pin (1) a short way into the square shaft.
- (4) Screw the locknuts (2) onto the square shaft. Do not tighten them yet.
- (5) Attach the drive bolt (3) to the threaded pin (1).

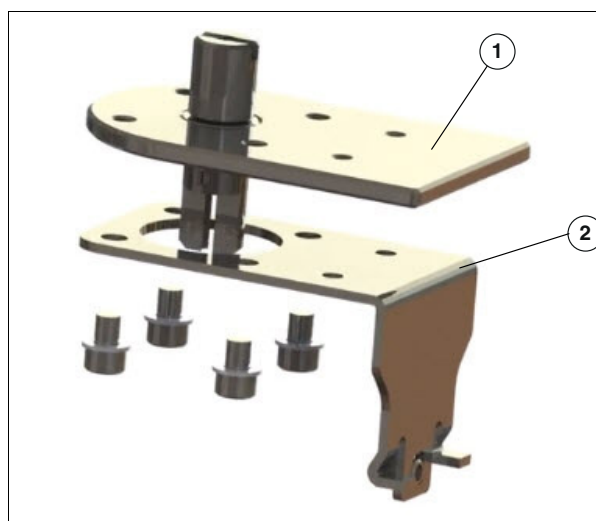

Figure 2

- (6) Attach the adapter plate (1) to the upper part of the mounting bridge (2) and tighten the four supplied M6 x 8 mm screws, including the washers, to a maximum tightening torque of 5 Nm.

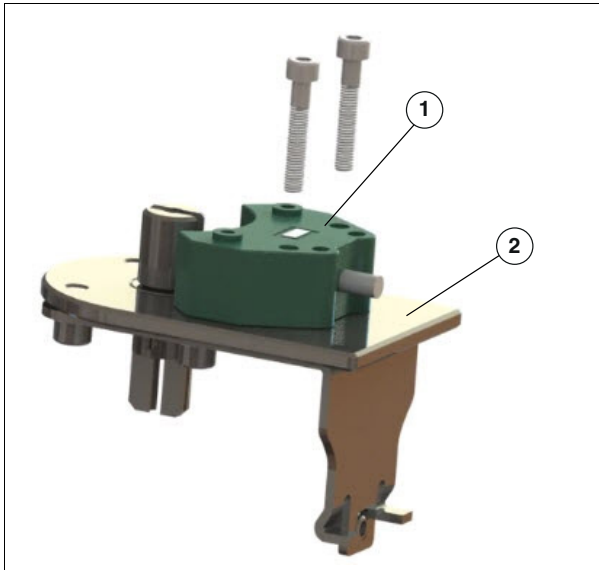

Figure 3

- (7) Secure the double sensor (1) to the adapter plate (2) using the two M5 screws.

i Note

The screws are included with the double sensor. The tightening torque can be found in the relevant datasheet.

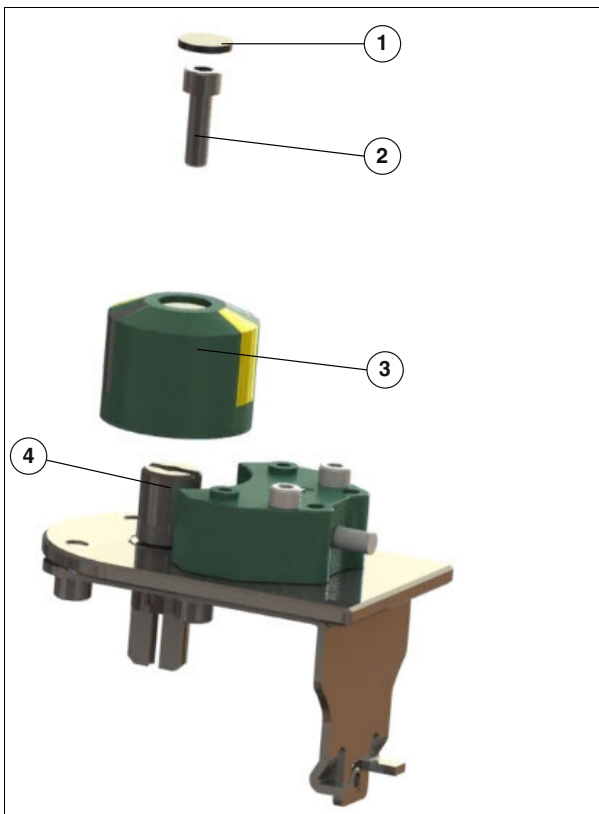
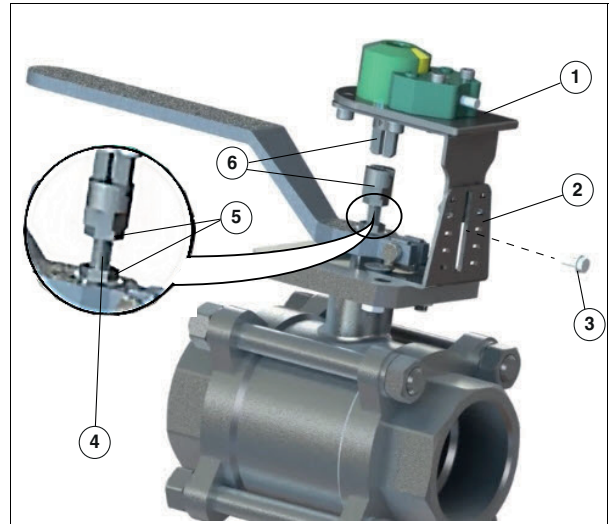

Figure 4

- (8) Secure the actuator (3) to the switching shaft (4) of the adapter plate (2) using an M6 screw (2).
- (9) On the actuator, use the cover (1) to conceal the screw.

i Note

The screw is included with the actuator. The tightening torque can be found in the relevant datasheet.



- (10) Fit the upper part (1) of the mounting bridge and the base (2) together correctly:

- The switching shaft (6) of the adapter plate must interlock with the drive bolt (6) and
- the two tabs of the upper part (1) must interlock with the slots on the base (2) at the desired position.
- By screwing in or unscrewing the threaded pin (4), you can adjust the distance between the switching shaft and the drive bolt (6).

- (11) Secure the connection between the upper part and the base by screwing in and tightening the M5 screw with the flat washer (3) to a maximum tightening torque of 3 Nm.

- (12) Secure the threaded pin in position by tightening the locknuts (5). Tighten the locknuts to the following torques, depending on the size:

- M5: max. 4.5 Nm
- M6: max. 8 Nm
- M8: max. 20 Nm
- M10: max. 40 Nm
- M12: max. 75 Nm