

SO-E Instrument housing with port-hole and extension

Description:

The SO-E instrument housing is made of aluminium alloy and circular shaped. It has a screwed cover with circular port-hole, extension and has different configuration for cable entry.

Application:

The SO-E instrument housing is suitable to contain signalling / visualization equipment.

Material:

Body and cover: copper free aluminium alloy.
 Port-hole: thermo-resistant tempered glass.
 Screws: stainless steel.

Certification characteristics:

Type of Protection: II 2GD Ex d IIC / Ex tD A21
 II 2GD Ex e II / Ex tD A21.
 Class of Temperature: T6 / T85 °C,
 T5 / T100 °C (only Ex e version).
 T4 / T135 °C.
 Protection Degree: IP66 / IP67*.
 Certificate: INERIS 01ATEX0023.
 Ambient Temperature: -50 / +60 °C (-20 / +40 °C).
 Zones: 1 – 21 – 2 – 22.

Threads:

NPT (ANSI B1.20.1).
 Metric x 1.5 (ISO 261).

Drawing SO-E

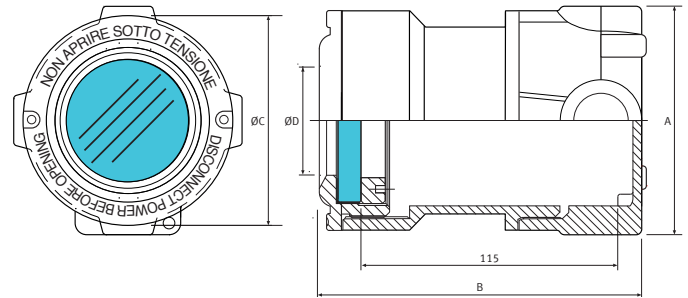

Legend:

- A - Maximum external dimension.
- B - Maximum external dimension with cover.
- Ø C - External diameter.
- Ø D - Port-hole diameter.

Drawing dimensions [mm].

Grounding:

Internal and external: M5 grounding point.

On request:

- *IP67 protection with o-ring.
- Anti loosening cover.
- Fixation brackets.
- External epoxy painting.
- Special inhibiting treatment.
- Cable glands for armoured or non armoured cable.

SO-E - Data Table

Dimensions [mm] and approx. Weight [Kg]

Type	Entries		Dimensions				Weight	
	n°	Ø [NPT]	A	B	Ø C	Ø D		
	SO-E/A 16	1	1/2"	100	144	90	49	0,85
	SO-E/A 26	1	3/4"	100	144	90	49	0,85
	SO-E/B 16	2	1/2"	100	144	90	49	0,85
	SO-E/B 26	2	3/4"	100	144	90	49	0,85
	SO-E/C 16	2	1/2"	100	144	90	49	0,85
	SO-E/C 26	2	3/4"	100	144	90	49	0,85
	SO-E/D 16	3	1/2"	100	144	90	49	0,85
	SO-E/D 26	3	3/4"	100	144	90	49	0,85
	SO-E/L 16	2	1/2"	100	144	90	49	0,85
	SO-E/L 26	2	3/4"	100	144	90	49	0,85
	SO-E/M 16	3	1/2"	100	144	90	49	0,85
	SO-E/M 26	3	3/4"	100	144	90	49	0,85
	SO-E/T 16	3	1/2"	100	144	90	49	0,85
	SO-E/T 26	3	3/4"	100	144	90	49	0,85
	SO-E/W 16	4	1/2"	100	144	90	49	0,85
	SO-E/W 26	4	3/4"	100	144	90	49	0,85

Note: - standard external grounding point close to the lower cable entry.

Release date 2011-01-24 - Updated 2013-06-03 - A2