



Model Number

CJ10-30GM-E1

Features

- Comfort series
- 10 mm non-flush

Connection

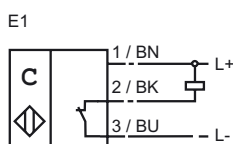

Dimensions

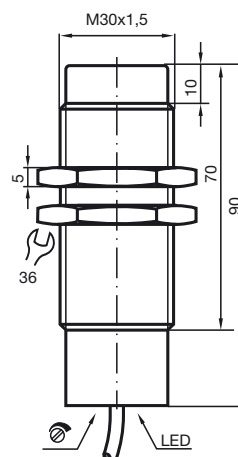

Technical Data

General specifications

| | | |
|----------------------------|-----------|-------------|
| Switching element function | NPN | NC |
| Rated operating distance | s_n | 10 mm |
| Installation | non-flush | |
| Output polarity | DC | |
| Assured operating distance | s_a | 0 ... 10 mm |

Nominal ratings

| | | |
|-----------------------------------|----------------------------|---------------------------|
| Installation conditions | | |
| A | 0 mm | |
| B | 0 mm | |
| C | 30 mm | |
| F | 50 mm | |
| Operating voltage | U_B | 10 ... 60 V |
| Switching frequency | f | 0 ... 10 Hz |
| Hysteresis | H | 0.1 ... 10 typ. 4 % |
| Reverse polarity protection | reverse polarity protected | |
| Short-circuit protection | pulsing | |
| Voltage drop | U_d | ≤ 2.8 V |
| Operating current | I_L | 0 ... 200 mA |
| Lowest operating current | I_m | 0 mA |
| Off-state current | I_r | 0 ... 0.5 mA typ. 0.01 mA |
| No-load supply current | I_0 | ≤ 20 mA |
| Time delay before availability | t_v | ≤ 50 ms |
| Indication of the switching state | LED, yellow | |

Standard conformity

| | |
|------------------------|-------------------------|
| EMC in accordance with | IEC / EN 60947-5-2:1999 |
|------------------------|-------------------------|

Ambient conditions

| | |
|---------------------|--------------------------------|
| Ambient temperature | -25 ... 70 °C (-13 ... 158 °F) |
| Storage temperature | -40 ... 85 °C (-40 ... 185 °F) |

Mechanical specifications

| | |
|--------------------|----------------------|
| Core cross-section | 0.75 mm ² |
| Housing material | Stainless steel |
| Sensing face | PBT |
| Protection degree | IP67 |

Installation conditions

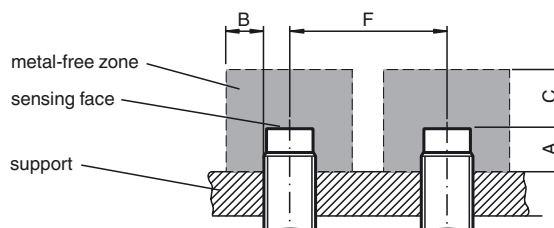

Release date: 2012-08-28 14:59 Date of issue: 2012-08-28 000017_eng.xml