



Model Number

NBN15-30GM50-Z0-V1

Features

- Basic series
- 15 mm not embeddable

Connection

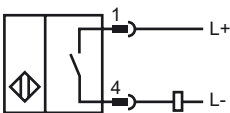

Pinout

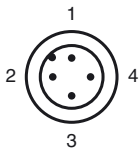

Wire colors in accordance with EN 60947-5-2

1	BN
2	WH
3	BU
4	BK

Release date: 2009-07-14 09:29 Date of issue: 2009-07-14 03:2059_ENG.xml

Dimensions

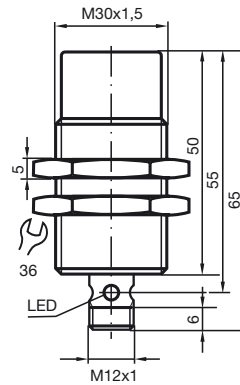

Technical Data

General specifications

Switching element function	DC	Make function
Rated operating distance	s_n	15 mm
Installation		not embeddable
Output polarity		DC
Assured operating distance	s_a	0 ... 12.2 mm
Reduction factor r_{Al}		0.4
Reduction factor r_{Cu}		0.35
Reduction factor r_{V2A}		0.7

Nominal ratings

Operating voltage	U_B	6 ... 60 V
Switching frequency	f	0 ... 500 Hz
Hysteresis	H	1 ... 10 typ. 5 %
Reverse polarity protection		tolerant
Short-circuit protection		no
Voltage drop	U_d	≤ 6 V
Operating current	I_L	4 ... 100 mA
Off-state current	I_r	0 ... 1 mA typ. 0.7 mA
Indication of the switching state		LED, yellow

Standard conformity

Standards	IEC / EN 60947-5-2:2004
-----------	-------------------------

Ambient conditions

Ambient temperature	-25 ... 70 °C (248 ... 343 K)
---------------------	-------------------------------

Mechanical specifications

Connection type	V1-connector
Cable version	PA
Housing material	brass, nickel-plated
Sensing face	PBT
Protection degree	IP67
Note	discontinued model