

Model number

VAA-2E1A-CB-N/E2-Y36498

Printed circuit board module 2 inputs / 1 output

Features

- AS-Interface certificate
- Inputs and outputs short-circuit and overload proof
- No external power supply required

Function

The AS-Interface interface module VAA-2E1A-CB-N/E2-Y36498 is the circuit board solution for an AS-Interface slave. The module is ideal for the integration in customer-specific electronics, e. g. key pads, actuators, etc. The printed circuit board is supplied wholly by the AS-Interface. The inputs and outputs are short-circuit and overload-proof.

Note:

In the case of communication errors on the AS-Interface line, the outputs are de-energised via an integrated watchdog.

This printed circuit board offers the possibility of short-notice, customer-specific designs (e. g.: 2EA, 2E1A, ...). It is also possible to change circuit board dimensions and plug connections.

Dimensions

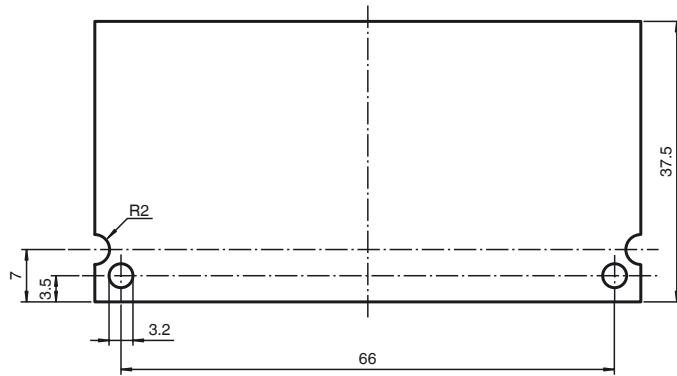

Electrical connection

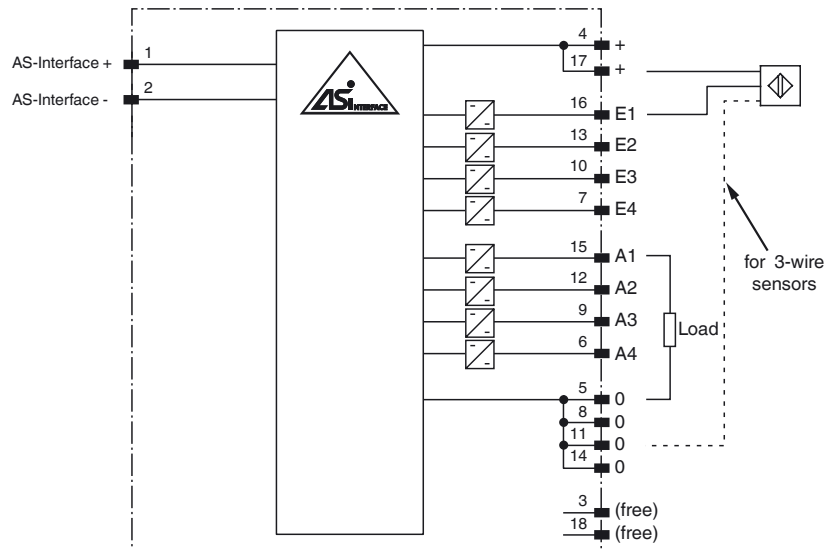

Indicating / Operating means

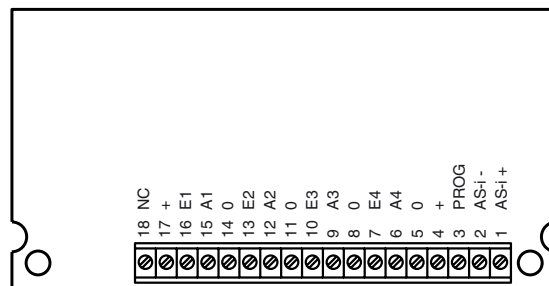

Release date: 2019-08-23 12:45 Date of issue: 2019-08-23 036498_eng.xml

Technical data**General specifications**

Slave type	Standard slave
------------	----------------

Electrical specifications

Rated operating voltage	U_e	26.5 ... 31.6 V from AS-Interface
-------------------------	-------	-----------------------------------

Rated operating current	I_e	≤ 150 mA
-------------------------	-------	---------------

Protection class	III
------------------	-----

Input

Number/Type	2 inputs for NAMUR Sensors
-------------	----------------------------

Supply	from AS-Interface
--------	-------------------

Voltage	8 V
---------	-----

Input current	≤ 8 mA (limited internally)
---------------	----------------------------------

Switching point	OFF ≤ 1.2 mA ON ≥ 2.1 mA according to DIN EN 60947-5-6
-----------------	--

Output

Number/Type	1 electronic output, PNP
-------------	--------------------------

Supply	from AS-Interface
--------	-------------------

Voltage	21 ... 31 V
---------	-------------

Current	max. 100 mA
---------	-------------

Programming instructions

Profile	S-7.0
---------	-------

IO code	7
---------	---

ID code	0
---------	---

Data bits (function via AS-Interface)	input	output
---------------------------------------	-------	--------

D0	-	OUT1 off
----	---	----------

D1	-	OUT1 on
----	---	---------

D2	IN1	-
----	-----	---

D3	IN2	-
----	-----	---

Parameter bits (programmable via AS-i)	function
--	----------

P0	not used
----	----------

P1	not used
----	----------

P2	not used
----	----------

P3	not used
----	----------

Ambient conditions

Ambient temperature	-25 ... 60 °C (-13 ... 140 °F)
---------------------	--------------------------------

Storage temperature	-25 ... 85 °C (-13 ... 185 °F)
---------------------	--------------------------------

Mechanical specifications

Degree of protection	IP00 (solder pins), IP20 (completely fitted); according to EN 60529
----------------------	--

Connection	Installed printed circuit board grid dimension 2.54 mm
------------	---