



CE

**Model Number**

NCN15-30GM70-B3

Features

- Comfort series
- NO/NC selectable
- Prefailure message and indicator

Accessories**BF 30**

Mounting flange, 30 mm

Technical Data**General specifications**

Switching function		Normally open/closed (NO/NC) programmable
Output type		AS-Interface
Rated operating distance	s_n	15 mm
Installation		non-flush
Assured operating distance	s_a	0 ... 12.1 mm
Reduction factor r_{Al}		0.38
Reduction factor r_{Cu}		0.36
Reduction factor r_{304}		0.72
Reduction factor r_{Brass}		0.45
Output type		2-wire

Nominal ratings

Operating voltage	U_B	26.5 ... 31.9 V via AS-i bus system
Switching frequency	f	0 ... 50 Hz
Hysteresis	H	typ. 5 %
Time delay before availability	t_v	≤ 1000 ms
Operating voltage indicator		LED green
Switching state indicator		LED yellow
Pre-fault indicator		LED red

Standard conformity

Standards	IEC / EN 60947-5-2:2004
-----------	-------------------------

Ambient conditions

Ambient temperature	-25 ... 70 °C (-13 ... 158 °F)
Storage temperature	-40 ... 85 °C (-40 ... 185 °F)

Mechanical specifications

Core cross-section	0.34 mm ²
Housing material	Stainless steel
Degree of protection	IP67

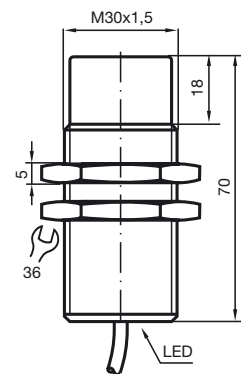
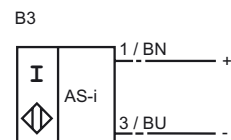
Dimensions**Electrical Connection**

Programming Instructions

Adresse 00 preset , alterable via Bus-master or programming units
 IO-code 1
 ID-code 1

Data bit

Bit	Function
D0	Switching state
D1	pre-fault signal (dynamic)
D2	ready for operation
D3	not used

Parameter bit

Bit	Function
P0	not used
P1	Switching element function NO* / NC
P2	not used
P3	not used

* Standard setting