

Model Number

PL1-F25-B3-S

Features

- For installation in housing
- With valve connection

Technical Data

General specifications	
Switching function	Normally open/closed (NO/NC) programmable
Output type	AS-Interface
Rated operating distance	s_n 3 mm
Installation	flush mountable
Assured operating distance	s_a 0 ... 2.43 mm
Reduction factor r_{AI}	0.5
Reduction factor r_{304}	1
Reduction factor r_{St37}	1.2
Output type	2-wire
Nominal ratings	
Operating voltage	U_B 26.5 ... 31.9 V via AS-i bus system
Switching frequency	f 0 ... 100 Hz
Reverse polarity protection	reverse polarity protected
Operating voltage indicator	LED, green
Switching state indicator	LED, yellow
Valve status indicator	LED, yellow
Standard conformity	
EMC in accordance with	IEC / EN 60947-5-2:2004
Standards	IEC / EN 60947-5-2:2004
Ambient conditions	
Ambient temperature	-25 ... 70 °C (-13 ... 158 °F)
Mechanical specifications	
Connection (system side)	screw terminals
Core cross-section (system side)	up to 2.5 mm ²
Connection (valve side)	screw terminals
Core cross-section (valve side)	up to 2.5 mm ²
Housing material	PBT
Sensing face	PBT
Degree of protection	IP20

Dimensions

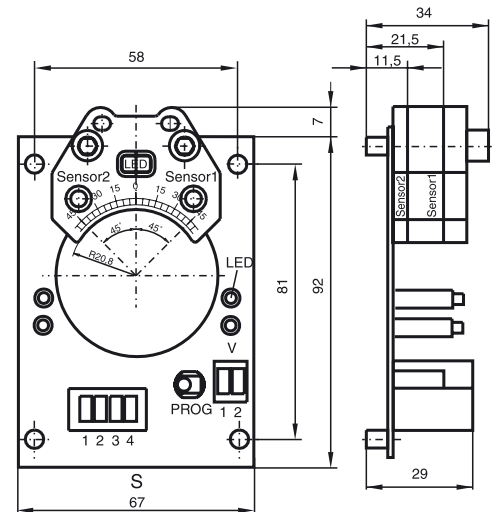

Electrical Connection

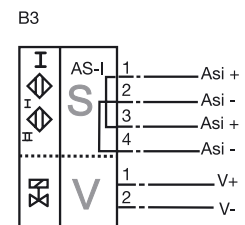

Release date: 2019-08-23 12:47 Date of issue: 2019-08-23 045612_eng.xml

Programming instructions

Address 00 preset, alterable via Busmaster or programming units
 IO-code D
 IO-code F

Data bit

Bit	function
D0	valve status (0 = valve OFF, 1 = valve ON)
D1	valve fault (0 = lead breakage/short circuit, 1= no fault) ¹⁾
D2	switch output sensor 1 (0 = damped; 1= undamped)
D3	switch output sensor 2 (0 = damped; 1= undamped)

Parameter bit

Bit	function
P0	not used
P1	not used
P2	not used
P3	not used

¹⁾ Verification only with actuated valve (D0 = 1)