

# Coupling

## 9409 6\*8



- Backlash-free, angle synchronous rotation transmission
- Very high torsion spring stiffness
- Material stainless steel and anodized aluminum

Bellows coupling

### Dimensions

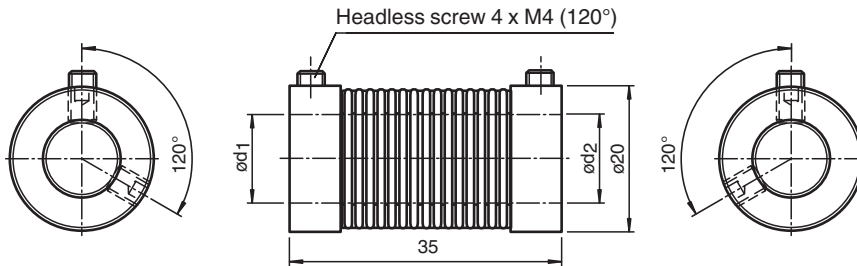

### Technical Data

<b>Ambient conditions</b>	
Ambient temperature	-30 ... 120 °C (-22 ... 248 °F)
<b>Mechanical specifications</b>	
Shaft diameter	d1 = 6 mm , d2 = 8 mm
Material	
Flange	anodized aluminum
Bellows	Stainless steel
Mass	approx. 16 g
Rotational speed	max. 10000 min <sup>-1</sup>
Max. torque	1 Nm
Tightening torque, fastening screws	1.5 Nm
Radial offset	max. ± 0.3 mm
Axial offset	max. ± 0.5 mm
Angle error	max. ± 4 °
Torsion spring stiffness	140 Nm / rad
Radial spring stiffness	10 N / mm
Moment of inertia	9 g cm <sup>2</sup>

Release date: 2022-12-10 Date of issue: 2022-12-12 Filename: 045771\_eng.pdf

Refer to "General Notes Relating to Pepperl+Fuchs Product Information".

Pepperl+Fuchs Group  
www.pepperl-fuchs.com

USA: +1 330 486 0001  
fa-info@us.pepperl-fuchs.com

Germany: +49 621 776 1111  
fa-info@de.pepperl-fuchs.com

Singapore: +65 6779 9091  
fa-info@sg.pepperl-fuchs.com

**PF** PEPPERL+FUCHS