

Coupling

9409 6*10



- Backlash-free, angle synchronous rotation transmission
- Very high torsion spring stiffness
- Material stainless steel and anodized aluminum

Bellows coupling

Dimensions

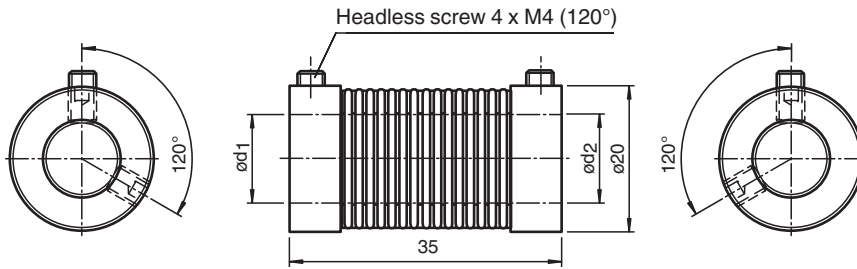

Technical Data

| | |
|-------------------------------------|---------------------------------|
| Ambient conditions | |
| Ambient temperature | -30 ... 120 °C (-22 ... 248 °F) |
| Mechanical specifications | |
| Shaft diameter | d1 = 6 mm , d2 = 10 mm |
| Material | |
| Flange | anodized aluminum |
| Bellows | Stainless steel |
| Mass | approx. 16 g |
| Rotational speed | max. 10000 min ⁻¹ |
| Max. torque | 1 Nm |
| Tightening torque, fastening screws | 1.5 Nm |
| Radial offset | max. ± 0.3 mm |
| Axial offset | max. ± 0.5 mm |
| Angle error | max. ± 4 ° |
| Torsion spring stiffness | 140 Nm / rad |
| Radial spring stiffness | 10 N / mm |
| Moment of inertia | 9 g cm ² |

Release date: 2022-12-10 Date of issue: 2022-12-12 Filename: 046667_eng.pdf

Refer to "General Notes Relating to Pepperl+Fuchs Product Information".

Pepperl+Fuchs Group
www.pepperl-fuchs.com

USA: +1 330 486 0001
fa-info@us.pepperl-fuchs.com

Germany: +49 621 776 1111
fa-info@de.pepperl-fuchs.com

Singapore: +65 6779 9091
fa-info@sg.pepperl-fuchs.com

PF PEPPERL+FUCHS