

Nut

LOCKNUT M16 NICKEL BRASS



Nut, nickel-plated brass

Dimensions

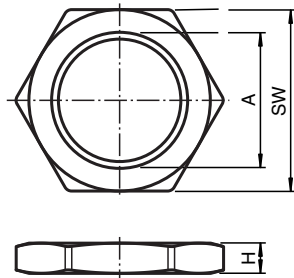

Technical Data

Mechanical specifications	
Material	brass, nickel-plated
Dimensions	
Height	5 mm
Width across flats	SW 24
Thread size	A = M16 x 1.5

Release date: 2023-11-30 Date of issue: 2023-11-30 Filename: 107579_eng.pdf

Refer to "General Notes Relating to Pepperl+Fuchs Product Information".

Pepperl+Fuchs Group
www.pepperl-fuchs.com

USA: +1 330 486 0001
fa-info@us.pepperl-fuchs.com

Germany: +49 621 776 1111
fa-info@de.pepperl-fuchs.com

Singapore: +65 6779 9091
fa-info@sg.pepperl-fuchs.com

 **PEPPERL+FUCHS**