

AS-Interface printed circuit board

VBA-4E3A-CB-E/E2-S

- A/B node with extended addressing possibility for up to 62 nodes
- Integrated communication monitoring function
- Inputs and outputs short-circuit and overload proof
- No external power supply required
- Connection via screw terminals

Printed circuit board module 4 inputs / 3 outputs



Function

The VBA-4E3A-CB-E/E2-S AS-Interface coupling module is the circuit board solution for an AS-Interface slave. The module is ideal for integration into customer-specific electronics, e. g. keypads, actuators, etc. The circuit board is supplied by the AS-Interface. The inputs and outputs are short-circuit and overload-proof.

Note:

In the case of communication errors on the bus, the outputs are de-energised via an integrated watchdog.

Pepperl+Fuchs can customise connectors and circuit board sizes e. g. for 2EA, 2E1A, ... models to meet your specific applications.

Dimensions

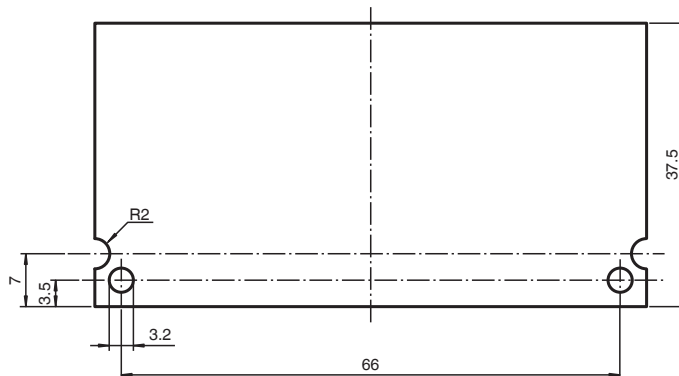

Technical Data

General specifications

Node type	A/B node
AS-Interface specification	V2.1
Required gateway specification	≥ V2.0

Electrical specifications

Rated operating voltage	U_e	26.5 ... 31.6 V from AS-Interface
Rated operating current	I_e	≤ 20 mA (without sensors)
Protection class		III

Input

Number/Type	Four inputs for mechanical contacts, two-wire and three-wire sensors
Supply	from AS-Interface
Voltage	21 ... 31 V

Release date: 2021-09-27 Date of issue: 2021-09-27 Filename: 121679_eng.pdf

Refer to "General Notes Relating to Pepperl+Fuchs Product Information".

Pepperl+Fuchs Group
www.pepperl-fuchs.com

USA: +1 330 486 0001
fa-info@us.pepperl-fuchs.com

Germany: +49 621 776 1111
fa-info@de.pepperl-fuchs.com

Singapore: +65 6779 9091
fa-info@sg.pepperl-fuchs.com

 PEPPERL+FUCHS

Technical Data

Input current	≤ 8 mA (limited internally)
Switching point	U _{in} < 2 V: aus> U _{in} > 10 V: on
Output	
Number/Type	3 electronic outputs, PNP
Supply	from AS-Interface
Voltage	21 ... 31 V
Current	≤ 80 mA per output, ≤ 80 mA total
Programming instructions	
Profile	S-7.A.E
IO code	7
ID code	A
ID2 code	E
Data bits (function via AS-Interface)	InputOutput
D0	IN1 OUT1
D1	IN2 OUT2
D2	IN3 OUT3
D3	IN4 -
Parameter bits (programmable via AS-i)	function
P0	not used
P1	not used
P2	not used
P3	not used
Ambient conditions	
Ambient temperature	-25 ... 70 °C (-13 ... 158 °F)
Storage temperature	-40 ... 70 °C (-40 ... 158 °F)
Mechanical specifications	
Degree of protection	IP20 (completely fitted) according to EN 60529
Connection	screw terminal strip

Assembly

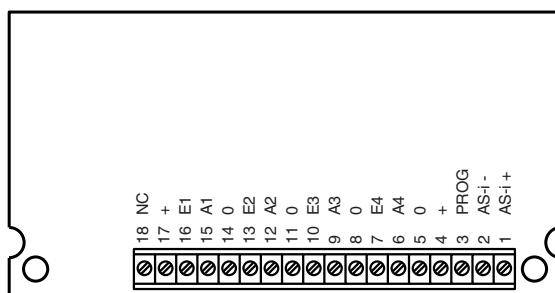

Connection

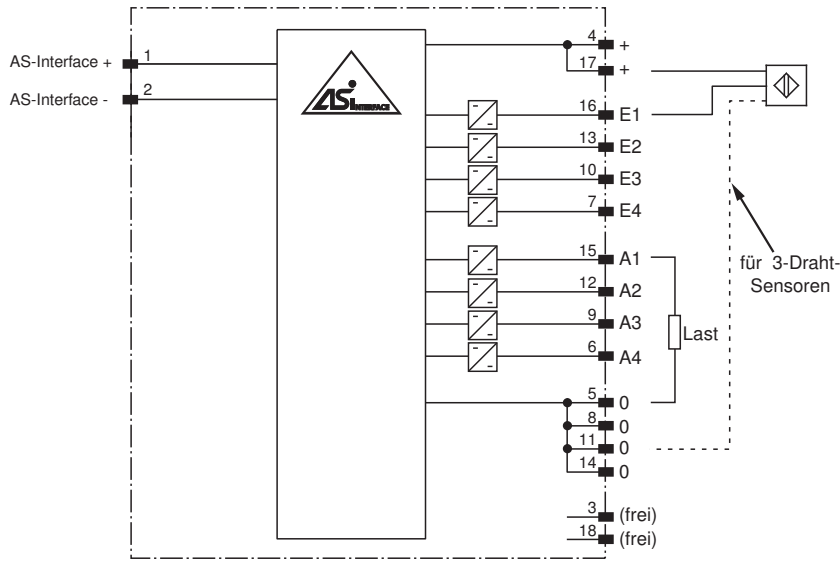

Release date: 2021-09-27 Date of issue: 2021-09-27 Filename: 121679_eng.pdf