

## Safety control unit module SB4 Module 4COP



- Sensor module
- 4 sensor channels
- Single module for safety thru-beam sensors SLA12 and SLA29 and for 2 channel safety devices (emergency off)
- Micro-Controller controls
- Operating mode can be selected by means of DIP switches

### Safety control unit module



### Dimensions

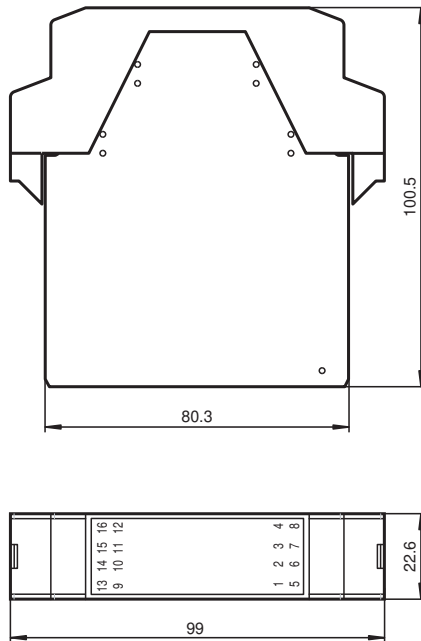

### Technical Data

#### General specifications

Operating mode ODER-Function

#### Functional safety related parameters

Safety Integrity Level (SIL) SIL 3  
 Performance level (PL) PL e  
 Category Cat. 4  
 Mission Time (T<sub>M</sub>) 20 a  
 Type 4

#### Indicators/operating means

Function indicator LED yellow (4x): indicator lamp channel 1 ... 4

Release date: 2023-02-15 Date of issue: 2023-02-15 Filename: 182561\_eng.pdf

Refer to "General Notes Relating to Pepperl+Fuchs Product Information".

Pepperl+Fuchs Group  
www.pepperl-fuchs.com

USA: +1 330 486 0001  
fa-info@us.pepperl-fuchs.com

Germany: +49 621 776 1111  
fa-info@de.pepperl-fuchs.com

Singapore: +65 6779 9091  
fa-info@sg.pepperl-fuchs.com

**PF** PEPPERL+FUCHS

**Technical Data**

Stability alarm indicator		LED yellow flashing: Indicator lamp channel 1 ... 4
Control elements		DIP switch
<b>Electrical specifications</b>		
Operating voltage	U <sub>B</sub>	24 V DC ± 20 % , via SB4 Housing
<b>Input</b>		
Activation current		approx. 7 mA
<b>Conformity</b>		
Functional safety		ISO 13849-1 ; EN 61508 part1-4
Product standard		EN 61496-1
<b>Approvals and certificates</b>		
CE conformity		CE
UL approval		cULus
TÜV approval		TÜV
<b>Ambient conditions</b>		
Ambient temperature		0 ... 50 °C (32 ... 122 °F)
Storage temperature		-20 ... 70 °C (-4 ... 158 °F)
<b>Mechanical specifications</b>		
Degree of protection		IP20
Connection		screw terminals , lead cross section 0.2 ... 2 mm <sup>2</sup>
<b>Material</b>		
Housing		Polyamide (PA)
Mass		approx. 150 g

**Connection**

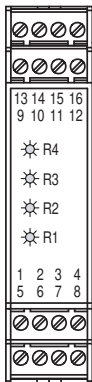

Terminal	Function	Channel assignment
1	Receiver 2 input	Channel 2
2	Receiver 2 +U	
3	Transmitter 2 +U	Channel 2
4	Transmitter 2 output	
5	Receiver 1 input	Channel 1
6	Receiver 1 +U	
7	Transmitter 1 +U	Channel 1
8	Transmitter 1 output	
9	Transmitter 3 output	Channel 3
10	Transmitter 3 +U	
11	Receiver 3 +U	Channel 3
12	Receiver 3 input	
13	Transmitter 4 output	Channel 4
14	Transmitter 4 +U	
15	Receiver 4 +U	Channel 4
16	Receiver 4 input	

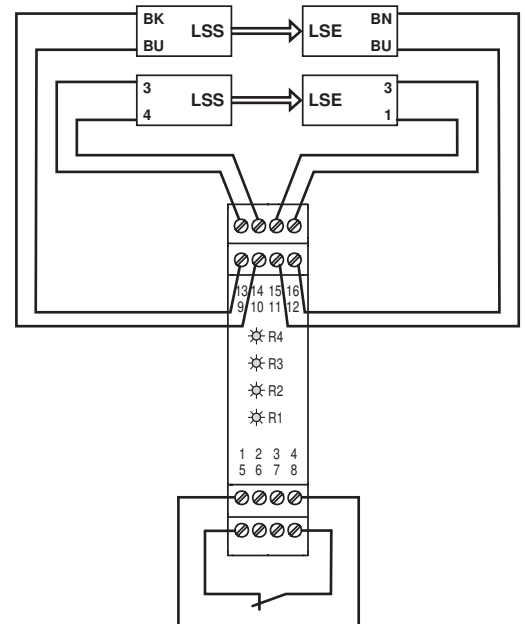

**Connection example**  
 (LSS = transmitter of light barrier;  
 LSE = receiver of light barrier)

Release date: 2023-02-15 Date of issue: 2023-02-15 Filename: 182561\_eng.pdf

This module can only be operated within an evaluation device of the SafeBox SB4 type.  
The SafeBox instruction manual should be observed.

### Function

The 4-channel sensor card module SB4-4COP makes it possible to connect light barriers or light grids or contact safety sensors in a one-channel version. Also, it contains the microcontroller control of the SafeBox.

This module is only contained once in a SafeBox SB4 and has to be mounted on slot 2. The module has a plug-in jumper. If the system contains additional assemblies, then this plug-in jumper has to be connected to the last slot.

When the system is switched on, the software determines whether a light barrier or a contact safety sensor is switched on at a channel and monitors its presence during operation.

Contact safety sensors, which are connected to the SafeBox, must work according to the normally closed principle. An open contact indicates "safe state".

The channels 1 and 2 as well as 3 and 4 can be combined via an OR function when using light barriers.



When using this function, it must be ensured that the effectiveness of the fusing is maintained. This must be checked on installation and commissioning .

### Operating modes

The assembly has 4 DIP switches for selecting the OR-operation of neighbouring channels (1 OR 2 and 3 OR 4). For selecting functions, 2 selector switches must always be actuated. The functions are only effective if light barriers are connected.

#### Position of the DIP switches

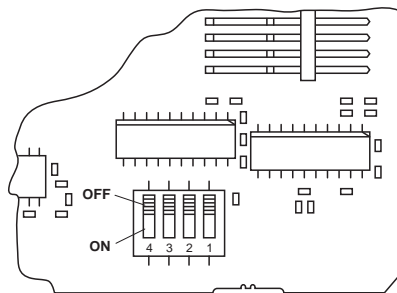

Switch	Position	Operation type
1 and 3	OFF	No OR-operation channel 1 and 2
	ON	OR-operation channel 1 and 2
2 and 4	OFF	No OR-operation channel 3 and 4
	ON	OR-operation channel 3 and 4

### Displays

For each channel, there is a yellow LED on the front panel of the module.

Display	LED	Meaning
R1 - R4	yellow	Status of light barrier 1 ... 4  Off: light beam interrupted On: light beam released  Flashing: light beam released, function reserve fallen short of (frequency approx. 2.5 Hz)  Flashing fast: error (frequency approx. 5 Hz)

Release date: 2023-02-15 Date of issue: 2023-02-15 Filename: 182561\_eng.pdf