

Inductive sensor

NBB4-12GM50-A2

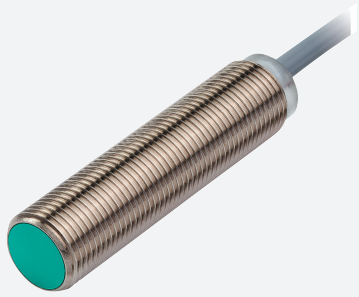

- 4 mm flush
- Increased operating distance



Dimensions

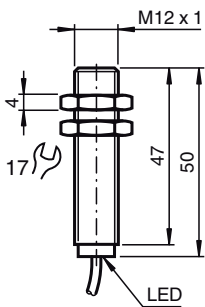

Technical Data

General specifications

| | | |
|----------------------------|-------|---------------|
| Switching function | | complementary |
| Output type | | PNP |
| Rated operating distance | s_n | 4 mm |
| Installation | | flush |
| Output polarity | | DC |
| Assured operating distance | s_a | 0 ... 3.24 mm |
| Reduction factor r_{Al} | | 0.39 |
| Reduction factor r_{Cu} | | 0.3 |
| Reduction factor r_{304} | | 0.7 |
| Output type | | 4-wire |

Nominal ratings

| | | |
|-----------------------------|-------|--|
| Operating voltage | U_B | 10 ... 30 V |
| Switching frequency | f | 0 ... 1500 Hz |
| Hysteresis | H | typ. 5% |
| Reverse polarity protection | | reverse polarity protected |
| Short-circuit protection | | pulsing |
| Voltage drop | U_d | ≤ 3 V |
| Operating current | I_L | 0 ... 200 mA |
| Off-state current | I_r | 0 ... 0.5 mA typ. 0.1 μ A at 25 °C |
| No-load supply current | I_0 | ≤ 20 mA |
| Switching state indicator | | LED, yellow |

Release date: 2020-03-23 Date of issue: 2020-03-30 Filename: 187646_eng.pdf

Refer to "General Notes Relating to Pepperl+Fuchs Product Information".

Pepperl+Fuchs Group
www.pepperl-fuchs.com

USA: +1 330 486 0001
fa-info@us.pepperl-fuchs.com

Germany: +49 621 776 1111
fa-info@de.pepperl-fuchs.com

Singapore: +65 6779 9091
fa-info@sg.pepperl-fuchs.com

PF PEPPERL+FUCHS



Technical Data

| Functional safety related parameters | |
|--|---|
| MTTF _d | 1560 a |
| Mission Time (T _M) | 20 a |
| Diagnostic Coverage (DC) | 0 % |
| Compliance with standards and directives | |
| Standard conformity | |
| Standards | EN 60947-5-2:2007 EN 60947-5-2/A1:2012 IEC 60947-5-2:2007 IEC 60947-5-2 AMD 1:2012 |
| Approvals and certificates | |
| UL approval | cULus Listed, General Purpose |
| CSA approval | cCSAus Listed, General Purpose |
| CCC approval | CCC approval / marking not required for products rated ≤36 V |
| Ambient conditions | |
| Ambient temperature | -25 ... 70 °C (-13 ... 158 °F) |
| Mechanical specifications | |
| Connection type | cable PVC , 2 m |
| Core cross-section | 0.14 mm ² |
| Housing material | brass, nickel-plated |
| Sensing face | PBT |
| Degree of protection | IP67 |
| Cable | |
| Cable diameter | 3.5 mm ± 0.2 mm |
| Bending radius | > 10 x cable diameter |
| General information | |
| Scope of delivery | 2 self locking nuts in scope of delivery |

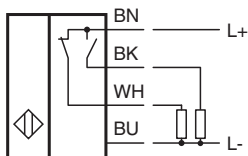
Connection



Accessories

| | | |
|---|---------------|---------------------------------------|
|  | BF 12 | Mounting flange, 12 mm |
|  | EXG-12 | Quick mounting bracket with dead stop |