



# Mounting aid DGE

## Weather Cap for REF-C110-2



- Protection from adverse effects of weather such as rain, snow, etc.

Weather hood for series reflector

### Dimensions

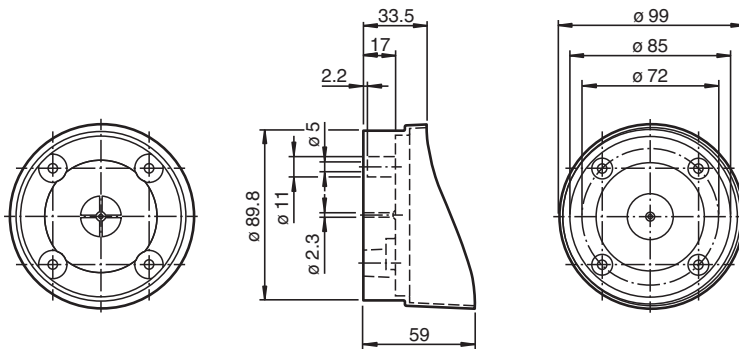

### Technical Data

#### Mechanical specifications

Material	plastic
Mass	approx. 60 g
Mounting	Mounting accessories included
<b>Suitable series</b>	
Reflector series	reflector C110-2

Release date: 2022-01-10 Date of issue: 2022-01-10 Filename: 198203\_eng.pdf

Refer to "General Notes Relating to Pepperl+Fuchs Product Information".

Pepperl+Fuchs Group  
www.pepperl-fuchs.com

USA: +1 330 486 0001  
fa-info@us.pepperl-fuchs.com

Germany: +49 621 776 1111  
fa-info@de.pepperl-fuchs.com

Singapore: +65 6779 9091  
fa-info@sg.pepperl-fuchs.com

**PF** PEPPERL+FUCHS