

End cap set for DoorScan® sensor profile



DoorScan End Caps

- End caps for DoorScan® sensing strip

End cap set for DoorScan® sensor profile

Dimensions

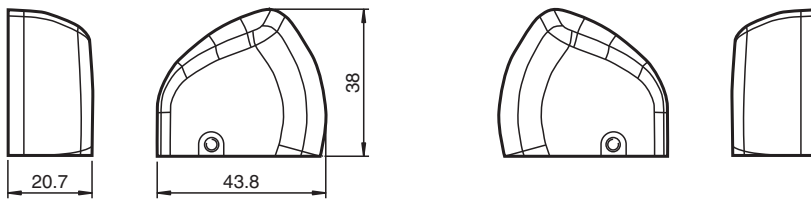

Technical Data

Ambient conditions	
Ambient temperature	-50 ... 150 °C (-58 ... 302 °F)
Mechanical specifications	
Material	Polyamide PA 66 black
Mass	approx. 16 g
General information	
Scope of delivery	2 units (1x each right and left) , 2 cross head screws, 3x16 mm
Suitable series	
Series	DoorScan®

Release date: 2020-09-10 Date of issue: 2020-10-08 Filename: 247290_eng.pdf

Refer to "General Notes Relating to Pepperl+Fuchs Product Information".

Pepperl+Fuchs Group
www.pepperl-fuchs.com

USA: +1 330 486 0001
fa-info@us.pepperl-fuchs.com

Germany: +49 621 776 1111
fa-info@de.pepperl-fuchs.com

Singapore: +65 6779 9091
fa-info@sg.pepperl-fuchs.com

PEPPERL+FUCHS