



Protective cover

SH-BT65-F31

- Protection against contamination and damage
- Captive screws for easy mounting

Protective cap for mechanical protection and for use in applications in conditions where moisture is present.

Dimensions

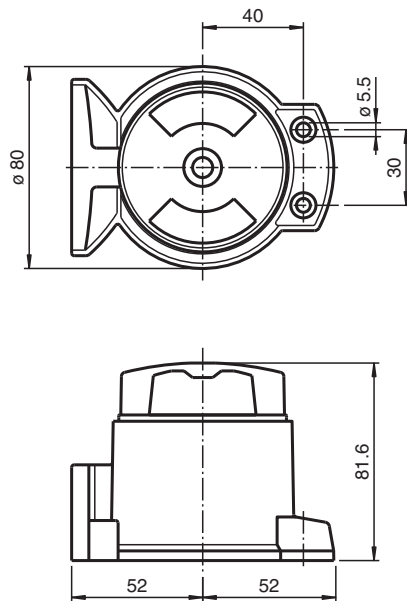

Technical Data

Mechanical specifications

Material: Polycarbonate

General information

Scope of delivery: 2 captive Fixing screws M5 x 16