

# Inductive slot sensor SJ3,5-S1N-Y303205

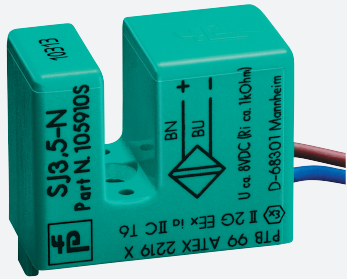

- 3.5 mm slot width
- Usable up to SIL 2 acc. to IEC 61508
- Nonferrous targets



## Dimensions

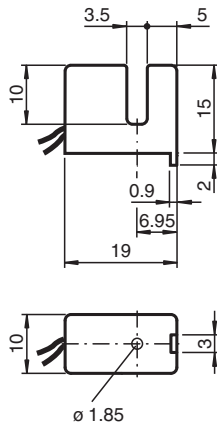

## Technical Data

### General specifications

Switching function	Normally open (NO)
Output type	NAMUR with safety function
Slot width	3.5 mm
Depth of immersion (lateral)	5 ... 7 typ. 6 mm
Reference target	10 x 7 x 0.3 mm <sup>3</sup> , Al
Safety Integrity Level (SIL)	up to SIL2 acc. to IEC 61508
Output type	2-wire

### Nominal ratings

Nominal voltage	U <sub>o</sub>	8.2 V
Switching frequency	f	0 ... 2500 Hz
Hysteresis	H	with NAMUR switch amplifier: 0.09 mm (e. g. Pepperl+Fuchs KCD2-SR-Ex1.LB)
Suitable for 2:1 technology		yes , with reverse polarity protection diode
Rate of current rise		2.1 mA / mm
Current consumption		
Measuring plate not detected		0.2 ... 1 mA

Release date: 2020-05-13 Date of issue: 2020-05-13 Filename: 303205\_eng.pdf

Refer to "General Notes Relating to Pepperl+Fuchs Product Information".

Pepperl+Fuchs Group  
www.pepperl-fuchs.com

USA: +1 330 486 0001  
fa-info@us.pepperl-fuchs.com

Germany: +49 621 776 1111  
fa-info@de.pepperl-fuchs.com

Singapore: +65 6779 9091  
fa-info@sg.pepperl-fuchs.com

**PEPPERL+FUCHS**

## Technical Data

Measuring plate detected	≥ 3 mA
<b>Functional safety related parameters</b>	
Safety Integrity Level (SIL)	SIL 2
MTTF <sub>d</sub>	11850 a
Mission Time (T <sub>M</sub> )	20 a
Diagnostic Coverage (DC)	0 %
<b>Compliance with standards and directives</b>	
Standard conformity	
NAMUR	EN 60947-5-6:2000 IEC 60947-5-6:1999
Standards	EN 60947-5-2:2007 EN 60947-5-2/A1:2012 IEC 60947-5-2:2007 IEC 60947-5-2 AMD 1:2012
<b>Approvals and certificates</b>	
FM approval	
Control drawing	116-0165
UL approval	
cULus Listed, General Purpose	
Ordinary Location	E87056
Hazardous Location	E501628
Control drawing	116-0454
CCC approval	CCC approval / marking not required for products rated ≤36 V
<b>Ambient conditions</b>	
Ambient temperature	-25 ... 100 °C (-13 ... 212 °F)
<b>Mechanical specifications</b>	
Connection type	flexible leads LiY , 500 mm
Core cross-section	0.14 mm <sup>2</sup>
Housing material	PBT
Degree of protection	IP67
Note	only for non-ferrous metal Adjustable stop
<b>General information</b>	
Use in the hazardous area	see instruction manuals

## Connection

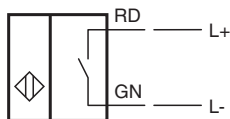

Release date: 2020-05-13 Date of issue: 2020-05-13 Filename: 303205\_eng.pdf

Refer to "General Notes Relating to Pepperl+Fuchs Product Information".

Pepperl+Fuchs Group  
www.pepperl-fuchs.com

USA: +1 330 486 0001  
fa-info@us.pepperl-fuchs.com

Germany: +49 621 776 1111  
fa-info@de.pepperl-fuchs.com

Singapore: +65 6779 9091  
fa-info@sg.pepperl-fuchs.com

 PEPPERL+FUCHS

## Operation

**Attention!**

NAMUR-compliant switch amplifiers can, due to a low current consumption when the measuring plate is not recorded (0.2 mA ... 1 mA), incorrectly report cable breaks (required in accordance with EN 60947-5-6:2000: 0.4 mA ... 1 mA).