

# Glass fiber optic

## LLE 18/30-2,3-2,0-WC14



Glass fiber optic - thru-beam with metal silicone covering

### Dimensions

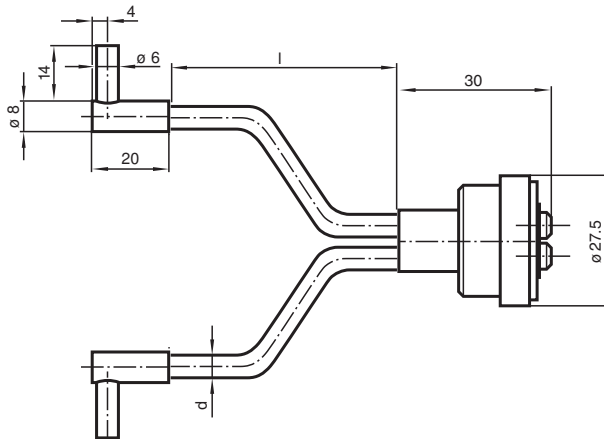

### Technical Data

#### General specifications

Fiber optic length	l	2000 mm
Fiber optic diameter	d	5.3 mm
Adapter form		18/30
End piece		Thread / cylindrical right angle
Bending radius		min. 22 mm
Fiber bundle diameter		2.3 mm
Angle of divergence		approx. 68 °

#### Approvals and certificates

Approvals		CE
-----------	--	----

#### Ambient conditions

Ambient temperature		-20 ... 95 °C (-4 ... 203 °F) [Adapter] -40 ... 180 °C (-40 ... 356 °F) [End head and Covering]
Storage temperature		-20 ... 85 °C (-4 ... 185 °F)

#### Mechanical specifications

Degree of protection		IP65
Material		

Release date: 2021-07-07 Date of issue: 2021-07-07 Filename: 415797\_eng.pdf

Refer to "General Notes Relating to Pepperl+Fuchs Product Information".

Pepperl+Fuchs Group  
www.pepperl-fuchs.com

USA: +1 330 486 0001  
fa-info@us.pepperl-fuchs.com

Germany: +49 621 776 1111  
fa-info@de.pepperl-fuchs.com

Singapore: +65 6779 9091  
fa-info@sg.pepperl-fuchs.com

**PF** PEPPERL+FUCHS

**Technical Data**

Optical face	glass
Sheathing	Metal-silicon
Core	Glass fiber
End piece	Stainless steel 1.4305 / AISI 303
Adapter	Polyamide PA 6.6
Extraction force	at probe at 20°C: 120 N
<b>Fiber optic amplifiers</b>	
Device series	GLV30

## Application

**Attention:**

Fiber optics must not be twisted or kinked. Excessive tensile loads will lead to destruction. Contact with petrol or organic solvents must be prevented.



Release date: 2021-07-07 Date of issue: 2021-07-07 Filename: 415797\_eng.pdf

Refer to "General Notes Relating to Pepperl+Fuchs Product Information".

Pepperl+Fuchs Group  
www.pepperl-fuchs.com

USA: +1 330 486 0001  
fa-info@us.pepperl-fuchs.com

Germany: +49 621 776 1111  
fa-info@de.pepperl-fuchs.com

Singapore: +65 6779 9091  
fa-info@sg.pepperl-fuchs.com