

Sensor module

AIR16

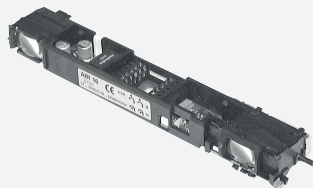

- Sensor module for configurable Topscan switch

Sensor module



Dimensions

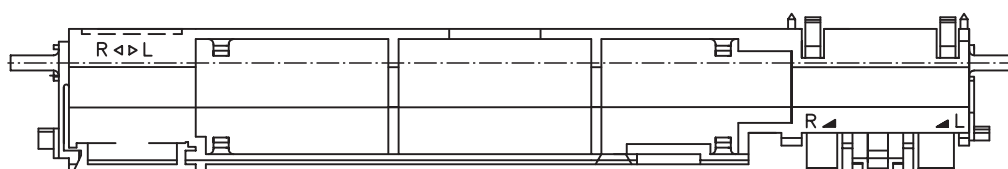
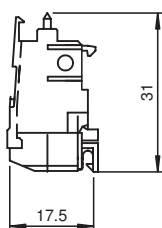
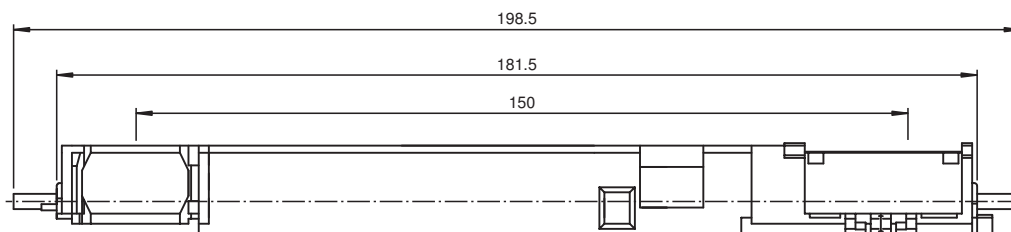

Technical Data

General specifications

Light source	IRED
Marking	CE
Operating mode	switching between background suppression/evaluation
Diameter of the light spot	75 x 75 mm by sensing range 2000 mm

Functional safety related parameters

MTTF _d	880 a
Mission Time (T _M)	20 a
Diagnostic Coverage (DC)	60 %

Indicators/operating means

Function indicator	LED red
Control elements	Sensing range adjuster, light-on/dark-on changeover switch, changeover switch for mode of operation

Release date: 2020-09-25 Date of issue: 2020-10-08 Filename: 419186_eng.pdf

Refer to "General Notes Relating to Pepperl+Fuchs Product Information".

Pepperl+Fuchs Group
www.pepperl-fuchs.com

USA: +1 330 486 0001
fa-info@us.pepperl-fuchs.com

Germany: +49 621 776 1111
fa-info@de.pepperl-fuchs.com









Singapore: +65 6779 9091
fa-info@sg.pepperl-fuchs.com

PEPPERL+FUCHS

Technical Data

Electrical specifications		
Operating voltage	U_B	17 ... 30 V DC , 18 ... 28 V AC
No-load supply current	I_0	< 100 mA
Output		
Switching type		Light-on/dark-on changeover switch
Signal output		Relay, 1 alternator
Switching voltage		max. 24 V DC , 48 V AC
Switching current		≤ 1 A
Switching power		24 W / 55 VA
Approvals and certificates		
CCC approval		CCC approval / marking not required for products rated ≤36 V
UN/ECE Regulation No. 10 (E1)		Type-approval number: 047349
Ambient conditions		
Ambient temperature		-20 ... 60 °C (-4 ... 140 °F)
Mechanical specifications		
Connection		screw terminals
Suitable series		
Series		TopScan

Accessories

	LAGERBOCK AIR16	Pedestal for the sensor module AIR16
	TopScan-S Cap Set	End cover for TopScan-S aluminum profile section
	TopScan-S Cable Loop Basic	Metal cable protector
	TopScan-S Cable 240 mm	Ribbon cable for connecting sensor modules
	TopScan2 Cable 300 mm	Ribbon cable for connecting sensor modules
	TopScan-S Cover L1400	Housing cover TopScan-S
	TopScan-S Gasket IP54	Housing seal TopScan-S
	TopScan-S Profile L1400	Housing profile TopScan-S

Release date: 2020-09-25 Date of issue: 2020-10-08 Filename: 419186_eng.pdf

Refer to "General Notes Relating to Pepperl+Fuchs Product Information".

Pepperl+Fuchs Group
www.pepperl-fuchs.com

USA: +1 330 486 0001
fa-info@us.pepperl-fuchs.com

Germany: +49 621 776 1111
fa-info@de.pepperl-fuchs.com

Singapore: +65 6779 9091
fa-info@sg.pepperl-fuchs.com

 **PEPPERL+FUCHS**