

Trip amplifier

1/209

- 4-channel
- Input 0/4 mA ... 20 mA
- 4 relay contact outputs
- Programmable
- Simple operation via front buttons
- Lead monitoring
- Galvanic isolation between input, power supply and contact output
- With computational function
- LCD display
- Self-monitoring

Trip amplifier with 1-4 trip values



Function

The programmable self-monitoring device is used to line monitor external set points, gradients, ratios or min/max selections. Set points are programmable via front push-buttons or PC. Input, power supply and relay contact output are galvanically isolated.

Connection

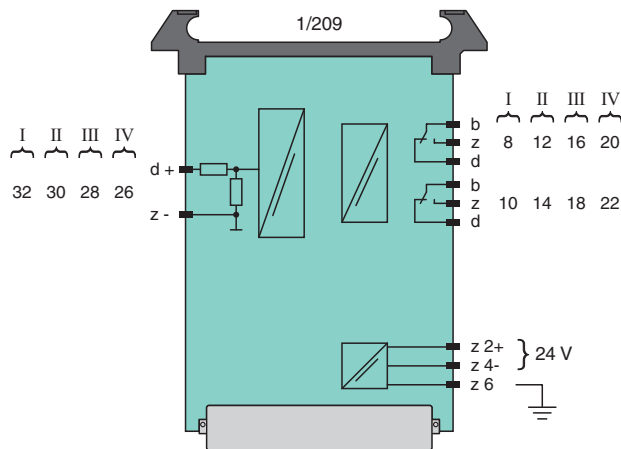

Release date: 2020-08-04 Date of issue: 2020-08-04 Filename: 542485_eng.pdf

Refer to "General Notes Relating to Pepperl+Fuchs Product Information".

Pepperl+Fuchs Group
www.pepperl-fuchs.com

USA: +1 330 486 0002
pa-info@us.pepperl-fuchs.com

Germany: +49 621 776 2222
pa-info@de.pepperl-fuchs.com

Singapore: +65 6779 9091
pa-info@sg.pepperl-fuchs.com

PF PEPPERL+FUCHS

Dimensions

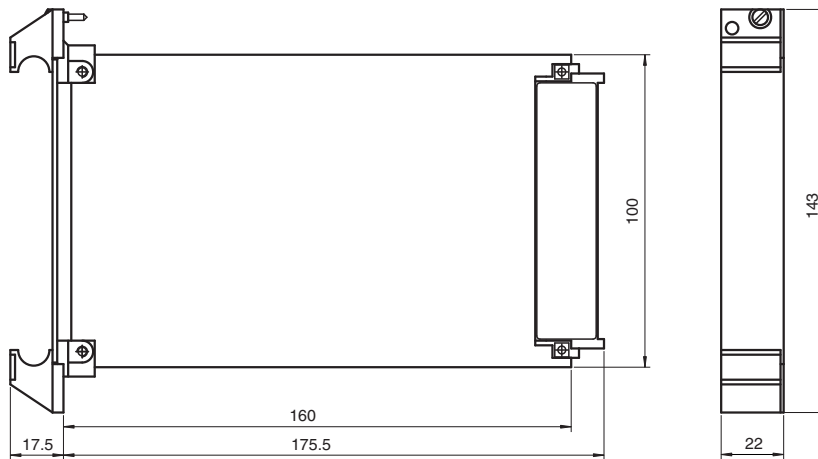

Technical Data

General specifications	
Signal type	Analog input
Supply	
Connection	z2+, z4-, z6 (PE)
Rated voltage	U _r 18 ... 30 V DC 18 ... 26.4 V AC
Power consumption	1.5 W / 2 VA
Input	
Connection	Input I: d32+, z32- Input II: d30+, z30- Input III: d28+, z28- Input IV: d26+, z26-
Input resistance	25 Ω (mA) 10 kΩ (V)
Current range	0/4 ... 20 mA (0/1 ... 5 V)
Output	
Connection	Output I: b8, z8, d8; b10, z10, d10 Output II: b12, z12, d12; b14, z14, d14 Output III: b16, z16, d16; b18, z18, d18 Output IV: b20, z20, d20; b22, z22, d22
Relay	
Switching voltage	50 V
Switching current	2 A AC/DC
Switching power	60 VA / 30 W
Mechanical life	10 Mio. cycles
Electrical life	0.5 Mio. cycles
Response time	> 20 ms (variable)
Transfer characteristics	
Temperature influence	< 0.1 %/10 K
Indicators/settings	
Display elements	LED 1: trip value 1 LED 2: trip value 2 LED 3: trip value 3 LED 4: trip value 4 LED green: Power on
Configuration	via RS-485 interface at the front side
Directive conformity	
Electromagnetic compatibility	
Directive 2004/108/EC	The device has been used for the same applications for several years. It therefore features an appropriate electromagnetic field immunity. The device must not be used in new plants.
Ambient conditions	

Release date: 2020-08-04 Date of issue: 2020-08-04 Filename: 542485_eng.pdf

Technical Data

Ambient temperature	-10 ... 60 °C (14 ... 140 °F)
Storage temperature	-25 ... 80 °C (-13 ... 176 °F)
Relative humidity	< 75 % (annual mean) < 95 % (30 d/year), no moisture condensation
Mechanical specifications	
Mass	300 g
Dimensions	22 x 143 x 193 mm (0.9 x 5.6 x 7.6 inch)
Construction type	Eurocard 100 x 160 mm (3.9 x 6.3 inch) acc. to DIN 41494, front panel 4TE, mountable in 19 inch rack
General information	
Supplementary information	Statement of Conformity, Declaration of Conformity, Attestation of Conformity and instructions have to be observed where applicable. For information see www.pepperl-fuchs.com .

Assembly

Front view

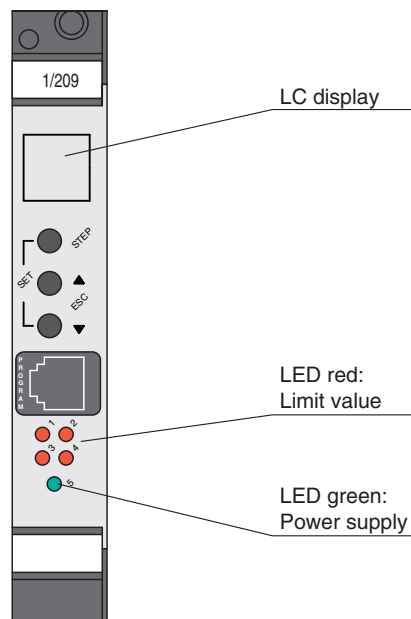

Product Versions

Type	Input	Output	Software	Model number
1/209	1 x 0/4 mA ... 20 mA	2 relays	1 min. / 1 max.	GHG 137 2011 B1016
1/209	4 x 0/4 mA ... 20 mA	4 relays	4 trip values	GHG 137 2041 B2066