



Trip amplifier

2/208

- 1-channel
- Input 0/4 mA ... 20 mA
- 2 relay contact outputs
- Simple operation via front buttons
- Lead monitoring
- Galvanic isolation between input, power supply and contact output
- LCD display
- Self-monitoring

Trip amplifier with 1-2 trip values



Function

The adjustable device is used to monitor trip values (min/max). The device is being operated via front push-buttons.

Connection

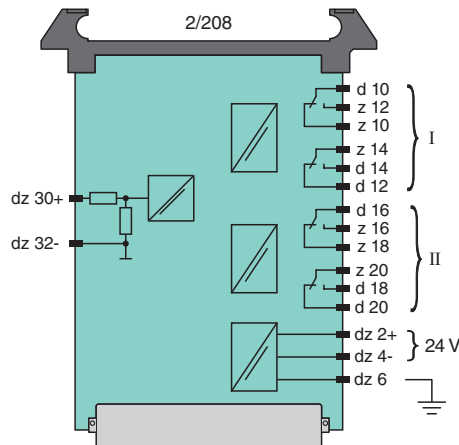

Dimensions

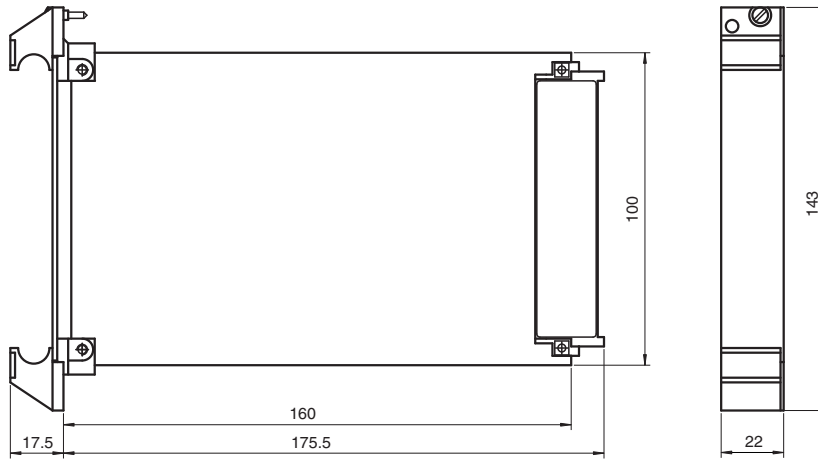

Technical Data

General specifications	
Signal type	Analog input
Supply	
Connection	dz2+, dz4-, dz6 (PE)
Rated voltage	U_r 20 ... 30 V DC 20 ... 26.4 V AC 48 ... 62 Hz
Power consumption	1.5 W / 2 VA
Input	
Connection	Input I: d32+, z32-
Input resistance	50 Ω (mA) 10 k Ω (V)
Current range	0/4 ... 20 mA (0/1 ... 5 V)
Output	
Connection	Output I: z10, d10, z12; d12, z14, d14 Output II: d20, z20, d18; z18, d16, z16
Relay	
Switching voltage	50 V
Switching current	1.25 A AC/DC
Switching power	60 VA / 30 W
Mechanical life	20 Mio. cycles
Electrical life	0.5 Mio. cycles
Response time	> 20 ms (variable)
Transfer characteristics	
Temperature influence	< 0.1 %/10 K
Indicators/settings	
Display elements	LED 1: trip value 1 LED 2: trip value 2 LED 3: lights up if measured value falls below trip value 1 LED 4: lights up if measured value falls below trip value 2
Directive conformity	
Electromagnetic compatibility	Directive 2004/108/EC
	The device has been used for the same applications for several years. It therefore features an appropriate electromagnetic field immunity. The device must not be used in new plants.
Ambient conditions	
Ambient temperature	-10 ... 60 °C (14 ... 140 °F)
Storage temperature	-25 ... 80 °C (-13 ... 176 °F)
Relative humidity	< 75 % (annual mean) < 95 % (30 d/year), no moisture condensation
Mechanical specifications	

Release date: 2020-08-04 Date of issue: 2020-08-04 Filename: 542488_eng.pdf

Refer to "General Notes Relating to Pepperl+Fuchs Product Information".

Pepperl+Fuchs Group
www.pepperl-fuchs.com

USA: +1 330 486 0002
pa-info@us.pepperl-fuchs.com

Germany: +49 621 776 2222
pa-info@de.pepperl-fuchs.com

Singapore: +65 6779 9091
pa-info@sg.pepperl-fuchs.com

PF PEPPERL+FUCHS

Technical Data

Mass	300 g
Dimensions	22 x 143 x 193 mm (0.9 x 5.6 x 7.6 inch)
Construction type	Eurocard 100 x 160 mm (3.9 x 6.3 inch) acc. to DIN 41494, front panel 4TE, mountable in 19 inch rack
General information	
Supplementary information	Statement of Conformity, Declaration of Conformity, Attestation of Conformity and instructions have to be observed where applicable. For information see www.pepperl-fuchs.com .

Assembly

Front view

