

IO-Link motor control module

ICA-8DIO4M1-G20-IO

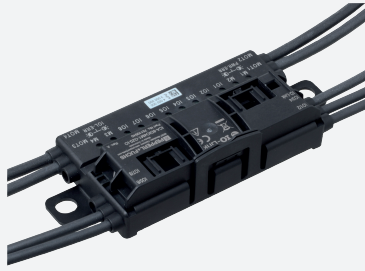

- Inputs for 2- and 3-wire sensors
- Electronic PNP outputs
- Connections for DC roller motors
- Configuration and control via IO-Link
- Function indicator for motors, inputs and outputs

G20 IO-Link module for digital inputs/outputs, 8 inputs and 8 outputs, 4 connections for roller motors



Function

The rollerdrive motor control module ICA-8DIO4M1-G20-IO* is a field module with 8 combined sensor inputs or electronic outputs. The 4 outputs for controlling DC rollerdrive motors are optimized for:

- Interroll EC310.
- Interroll EC5000 24V AI (20W / 35W / 50W)
- Rulmeca BL3
- Itoh Denki PM500XK
- Itoh Denki PM500XC
- PULSEROLLER Senergy-IDC

The compact housing can be mounted directly into support profiles or cable ducts. The power supply U_{PWR} is connected by piercing technology via the black AS-Interface flat cable. The swiveling flat cable guide locks without tools by a snap-fit. The combined inputs and outputs and the motor outputs are connected using cable outputs with M8 round connectors. The inputs and outputs have 4-pin female connectors with locking nut, the motor outputs have 5-pin snap-on female connectors. IO-Link is connected using a cable output with M12 4-pin round plug connector. The inputs and outputs are supplied via IO-Link. The motor outputs are supplied via U_{PWR} . The LEDs IO display the current switching state and as well a fault condition of the combined inputs/outputs. The LEDs M display the operating state of the motors (stop/run/fault). The module is configured via IO-Link.

Dimensions

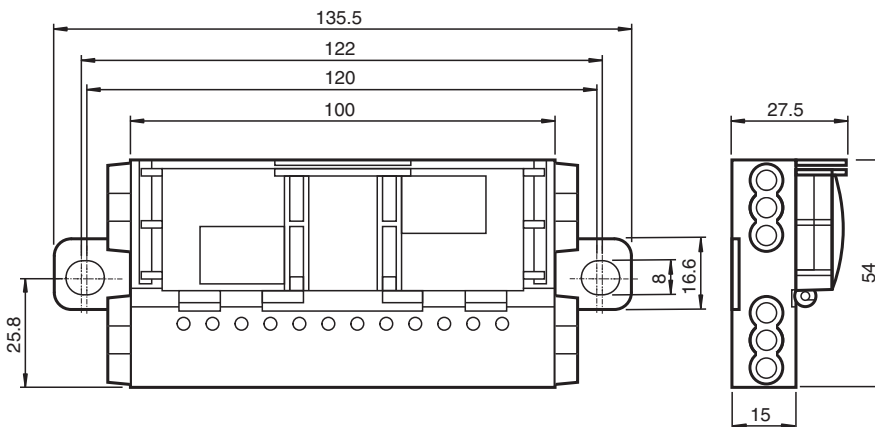

Technical Data

General specifications

UL File Number	E223772 "For use in NFPA 79 Applications only"
MTBF	90 a
Compatible roller motors	Interroll EC310, Interroll EC5000 24V AI (20W / 35W / 50W), Rulmeca BL3, Itoh Denki PM500XK, Itoh Denki PM500XC, PULSEROLLER Senergy-IDC

Indicators/operating means

Refer to "General Notes Relating to Pepperl+Fuchs Product Information".

Technical Data

LED yellow/red	IO1 ... IO8: IO-Link status MOT1 ... MOT4: motor status
Electrical specifications	
Auxiliary voltage	U_{PWR} 18 ... 30 VDC PELV Max. 10 A Current limitation of the supply max. 30 A For UL: Z-type miniature circuit breaker in accordance with UL 1077, max. 20 A, required
Operating voltage	U_B 18 ... 30 V DC, PELV Max. 2.5 A (IO-Link) Current limitation of the supply max. 4 A
No-load supply current	I_0 ≤ 25 mA
Operating current	I_B max. 2.5 A
Interface	
Interface type	IO-Link
IO-Link revision	1.1
Device profile	Identification and Diagnosis - I&D
Process data	8 byte inputs (STD/EXT) 6 byte outputs (STD) 18 byte outputs (EXT)
Vendor ID	1 (0x0001)
Device ID	Rev. A: 984066 (0x0F0402) (STD) - default 984065 (0x0F0401) (EXT) Rev. B: 984066 (0x0F0402) (STD) 984065 (0x0F0401) (EXT) 984070 (0x0F0406) (STD) - default 984069 (0x0F0405) (EXT)
Data transfer rate	COM3 (230.4 kbits/s)
Min. cycle time	1.2 ms (STD) 2 ms (EXT)
SIO mode support	no
Compatible master port type	Class A
Input	
Number/Type	8 Inputs for 3-wire sensors (PNP), DC (IO1 ... IO8)
Supply	from IO-Link
Current loading capacity	200 mA , overload and short-circuit protected
Input current	≤ 5 mA (limited internally)
Switching point	Type 3 according to IEC 61131-2
Output 1	
Number/Type	8 electronic outputs, PNP (IO1 ... IO8), overload proof and short-circuit proof
Supply	from IO-Link
Current	200 mA per output
Voltage	$\geq (U_e - 1.5$ V)
Output 2	
Number/Type	4 outputs for DC roller motors (MOT1 ... MOT4)
Supply	via U_{PWR}
Current loading capacity	3.5 A (continuous), 5 A (< 2 s), max. 7.5 A (< 0.3 s) per motor Total current (continuous) max. 10 A per device
Overload protection	Fuse 5 A, $I^2t = 53.7$ A ² s per motor
Signal level	Speed: $U_S = 0.3 \dots 10$ V in no-load operation $R_i = 5.6$ k Ω , $R_{LOAD} \geq 35$ k Ω Direction of rotation: Digital output PNP U_D low = high resistance U_D high $\geq (U_{PWR} - 0.5$ V) Current-carrying capacity 400 mA, overload proof and short-circuit proof
Fault level	Motor fault: Digital input NPN 0 (no error) ≥ 125 μ A 1 (error) ≤ 25 μ A
Output 3	
Number/Type	4 electronic outputs, PNP (DIR/OUT1 ... DIR/OUT4), overload and short-circuit proof
Supply	via U_{PWR}

Release date: 2024-03-06 Date of issue: 2024-03-06 Filename: 70110940_eng.pdf

Refer to "General Notes Relating to Pepperl+Fuchs Product Information".

 Pepperl+Fuchs Group
www.pepperl-fuchs.com

 USA: +1 330 486 0001
fa-info@us.pepperl-fuchs.com

 Germany: +49 621 776 1111
fa-info@de.pepperl-fuchs.com

 Singapore: +65 6779 9091
fa-info@sg.pepperl-fuchs.com

 **PEPPERL+FUCHS**

Technical Data

Current	400 mA per output
Voltage	$\geq (U_{PWR} - 0.5 \text{ V})$
Directive conformity	
Electromagnetic compatibility	
Directive 2014/30/EU	EN 61326-1:2013 EN 55011:2016
Standard conformity	
Degree of protection	EN 60529:2000
Fieldbus standard	EN 61131-9:2013
Input	EN 61131-2:2007
Communication interface	IEC 61131-9 / IO-Link V1.1.2
Emitted interference	EN 61000-6-4:2007
Noise immunity	EN 61000-6-2:2005, EN 61326-1:2006
Ambient conditions	
Ambient temperature	-25 ... 70 °C (-13 ... 158 °F)
Storage temperature	-25 ... 70 °C (-13 ... 158 °F)
Relative humidity	85 % non-condensing
Climatic conditions	For indoor use only
Altitude	$\leq 2000 \text{ m}$ above MSL
Shock and impact resistance	30 g, 11 ms in 6 spatial directions, 3 shocks 10 g, 16 ms in 6 spatial directions, 1000 shocks
Vibration resistance	0.35 mm / 5 g 5 ... 500 Hz
Pollution degree	2
Mechanical specifications	
Degree of protection	IP54 according to EN 60529
Connection	24 V power (PWR): Piercing technology, black flat cable IO-Link: M12 round plug connector in accordance with EN 61076-2-101, LM type (4-pin, connector contacts, screw-locking, A-coded) Female connector: LF type or similar Inputs/outputs (IO), motors (MOT): M8 round plug connector in accordance with EN 61076-2-104 IO: LF type (4-pin, bushing contacts, screw-locking, A-coded) Female connector: LM type or similar MOT: NF type (5-pin, bushing contacts, snap-locking, B-coded) Female connector: NM type or similar
Mass	310 g
Dimensions	
Height	27.5 mm
Width	131.5 mm
Length	54 mm
Mounting	2 clips with $\varnothing 8 \text{ mm}$ drill hole The module must be secured to a solid, continuous surface using the two lugs
Cable length	1 m (IO-Link) 0.5 m (IO1/2, IO5/6), 0.65 m (IO3/4, IO7/8) 0.5 m (MOT1, MOT3); 0.4 m (MOT2, MOT4) max. 10 m
Note	The flat cable routing is designed for 100 actuation cycles

Release date: 2024-03-06 Date of issue: 2024-03-06 Filename: 70110940_eng.pdf

Connection

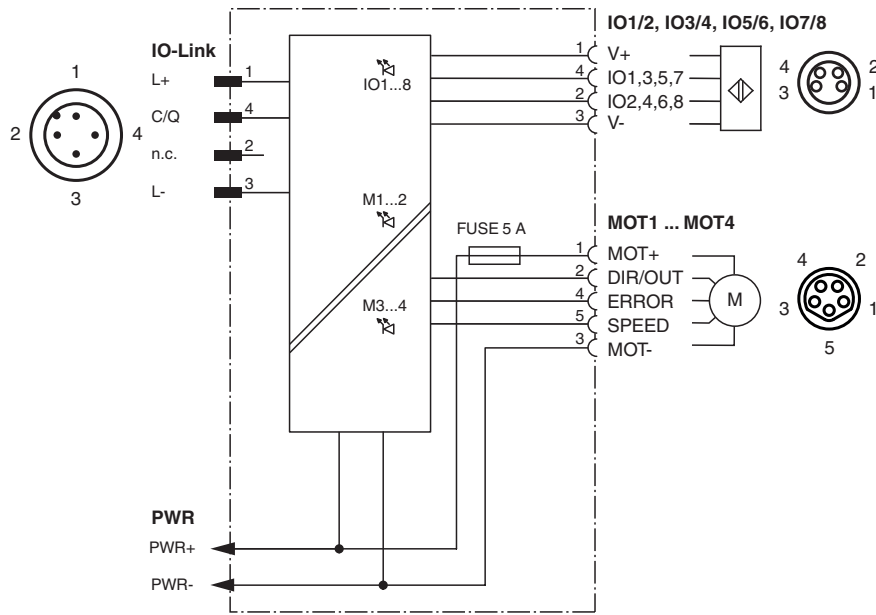

Indication

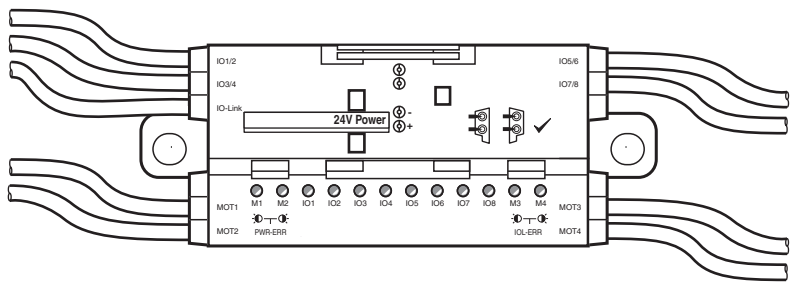

Release date: 2024-03-06 Date of issue: 2024-03-06 Filename: 70110940_eng.pdf