

Locknuts

LN.M25.BN.55.K50

- Brass nickel-plated
- Thread M25
- Packaging unit: 50 pieces

Dimensions

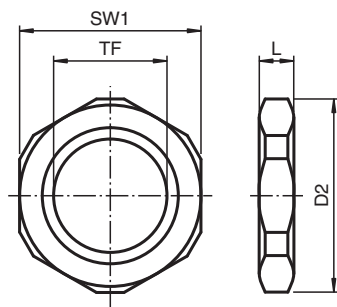

Dimension values see data table.

Image and drawing are generic for this component type and may deviate from the specific variant.

Legend

D2	Width across corners
L	Total length
SW1	Width across flats
TF	Thread size female

Technical Data

Mechanical specifications

Thread type	metric ISO pitch 1.5 mm
Thread size female (TF)	M25
Material	brass, nickel-plated
Finish	inherent color silver
Dimensions	
Width across corners (D2)	33 mm
Width across flats (SW1)	30 mm
Total length (L)	5.5 mm

Release date: 2020-08-05 Date of issue: 2020-08-05 Filename: 70125288_eng.pdf

Refer to "General Notes Relating to Pepperl+Fuchs Product Information".

Pepperl+Fuchs Group
www.pepperl-fuchs.com

USA: +1 330 486 0002
pa-info@us.pepperl-fuchs.com

Germany: +49 621 776 2222
pa-info@de.pepperl-fuchs.com









Singapore: +65 6779 9091
pa-info@sg.pepperl-fuchs.com

PF PEPPERL+FUCHS

Technical Data

General information	
Delivery quantity	50
Scope of delivery	Locknuts

Matching system components

	AD.M25.M20.BN. C.15.K35
	AD.M25.NPT1.BN. C.15.K35
	AD.M25.NPT1.SS. C.15.K35
	AD.M25.NPT1/2.BN. C.15.K35
	AD.M25.NPT1/2.SS. C.15.K35
	AD.M25.NPT3/4.BN. C.15.K35
	AD.M25.NPT3/4.SS. C.15.K35
	SP.MD.M25.BN.C.15.K50
	SP.MD.M25.SS.C.15.K50
	SP.PE.M25.PA.C.15.K25

Release date: 2020-08-05 Date of issue: 2020-08-05 Filename: 70125288_eng.pdf