

Inductive slot sensor

SJ3,5-SN-Y89604

- 3.5 mm slot width
- Usable up to SIL 3 acc. to IEC 61508
- Ferrous targets



Function

The inductive slot sensors are suitable for use in particularly tight installation spaces, e.g. for limit detection in pointer instruments. In addition to the reference target, ferromagnetic metals can also be used as actuator elements. With a variety of approvals for use in hazardous areas, the sensors are equipped for global use.

In combination with a safety switch amplifier from Pepperl+Fuchs, e.g. KFD2-SH-EX1, use in safety-related applications up to SIL 3 is possible. The sensor can also be used in applications up to SIL 2 with safety-related NAMUR switch amplifiers.

Dimensions

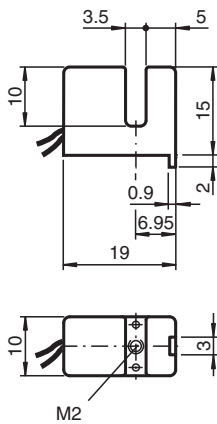

Technical Data

General specifications

Switching function	Normally closed (NC)
Output type	NAMUR with safety function
Slot width	3.5 mm
Depth of immersion (lateral)	5 ... 7 typ. 6 mm
Reference target	10 x 7 x 0.3 mm ³ , Al
Output type	2-wire

Nominal ratings

Nominal voltage	U _o	8.2 V (R _i approx. 1 kΩ)
Switching frequency	f	0 ... 3000 Hz
Hysteresis	H	with NAMUR switch amplifier: 0.045 mm (e. g. Pepperl+Fuchs KCD2-SR-Ex1.LB) with safety switch amplifier 0.025 mm (e. g. Pepperl+Fuchs KFD2-SH-Ex1)

Release date: 2023-01-27 Date of issue: 2023-01-27 Filename: 70133011_eng.pdf

Refer to "General Notes Relating to Pepperl+Fuchs Product Information".

Pepperl+Fuchs Group
www.pepperl-fuchs.com

USA: +1 330 486 0001
fa-info@us.pepperl-fuchs.com

Germany: +49 621 776 1111
fa-info@de.pepperl-fuchs.com

Singapore: +65 6779 9091
fa-info@sg.pepperl-fuchs.com

PEPPERL+FUCHS

Technical Data

Rate of current rise		-4.5 mA / mm
Current consumption		
Measuring plate not detected		≥ 3 mA
Measuring plate detected		0.2 ... 1 mA
Functional safety related parameters		
Safety Integrity Level (SIL)		SIL 3
MTTF _d		11800 a
Mission Time (T _M)		20 a
Diagnostic Coverage (DC)		0 %
Compliance with standards and directives		
Standard conformity		
NAMUR		EN 60947-5-6:2000 IEC 60947-5-6:1999
Standards		EN 60947-5-2:2007 EN 60947-5-2/A1:2012 IEC 60947-5-2:2007 IEC 60947-5-2 AMD 1:2012
Approvals and certificates		
IECEX approval		
Equipment protection level Gb		IECEX PTB 11.0092X
Equipment protection level Da		IECEX PTB 11.0092X
Equipment protection level Mb		IECEX PTB 11.0092X
ATEX approval		
Equipment protection level Gb		PTB 00 ATEX 2049 X
Equipment protection level Da		PTB 00 ATEX 2049 X
UL approval		cULus Listed, General Purpose
CCC approval		
Hazardous Location		2020322315002308
NEPSI approval		
NEPSI certificate		GYJ16.1392X
Ambient conditions		
Ambient temperature		-40 ... 100 °C (-40 ... 212 °F)
Mechanical specifications		
Connection type		flexible leads LiY
Housing material		PBT
Degree of protection		IP67
Cable		
Cable diameter		1.1 mm ± 0.1 mm
Bending radius		> 10 x cable diameter
Material		PVC
Core cross section		0.14 mm ²
Length	L	135 mm
General information		
Use in the hazardous area		see instruction manuals

Connection

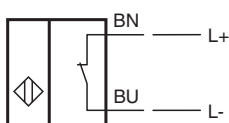

Application

**Danger!**

In safety-related applications the sensor must be operated with a qualified fail safe interface from Pepperl+Fuchs, such as KFD2-SH-EX1.

Consider the "exida Functional Safety Assessment" document which is available on www.pepperl-fuchs.com as an integral part of this product's documentation.