



## Inductive sensor

NJ1,5-18GM-N-D-V1-Y29033

- 1.5 mm flush
- Compression proof up to 350 bar, dynamic on active surface



### Dimensions

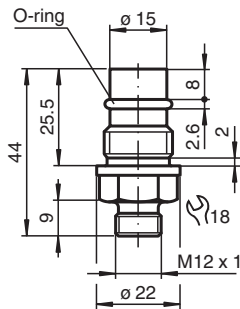

### Technical Data

General specifications		
Switching function		Normally closed (NC)
Output type		NAMUR
Rated operating distance	$s_n$	1.5 mm
Installation		flush
Assured operating distance	$s_a$	0 ... 1.22 mm
Reduction factor $r_{AI}$		0
Reduction factor $r_{Cu}$		0
Reduction factor $r_{304}$		0.55
Output type		2-wire
Nominal ratings		
Nominal voltage	$U_o$	8 V
Switching frequency	$f$	0 ... 400 Hz
Hysteresis	$H$	typ. %
Current consumption		
Measuring plate not detected		min. 3 mA
Measuring plate detected		≤ 1 mA

Release date: 2024-01-09 Date of issue: 2024-01-09 Filename: 70139683\_eng.pdf

Refer to "General Notes Relating to Pepperl+Fuchs Product Information".

Pepperl+Fuchs Group  
www.pepperl-fuchs.com

USA: +1 330 486 0001  
fa-info@us.pepperl-fuchs.com

Germany: +49 621 776 1111  
fa-info@de.pepperl-fuchs.com

Singapore: +65 6779 9091  
fa-info@sg.pepperl-fuchs.com

PEPPERL+FUCHS

## Technical Data

<b>Limit data</b>		
Operating pressure		350 bar (5076.4 psi)
<b>Compliance with standards and directives</b>		
Standard conformity		
NAMUR		EN 60947-5-6:2000 IEC 60947-5-6:1999
Standards		EN 60947-5-2:2007 EN 60947-5-2/A1:2012 IEC 60947-5-2:2007 IEC 60947-5-2 AMD 1:2012
<b>Approvals and certificates</b>		
IECEX approval		
Equipment protection level Gb		IECEX PTB 11.0037X
Equipment protection level Da		IECEX PTB 11.0037X
Equipment protection level Mb		IECEX PTB 11.0037X
ATEX approval		
Equipment protection level Gb		PTB 00 ATEX 2048 X
Equipment protection level Da		PTB 00 ATEX 2048 X
UL approval		cULus Listed, Class 2 Power Source
CML approval		on request
<b>Ambient conditions</b>		
Ambient temperature		-25 ... 85 °C (-13 ... 185 °F)
<b>Mechanical specifications</b>		
Connection type		4-pin, M12 x 1 connector
Housing material		Stainless steel 1.4305 / AISI 303
Sensing face		Ceramic
Degree of protection		IP67
Dimensions		
Length		35 mm
Diameter		18 mm
<b>General information</b>		
Use in the hazardous area		see instruction manuals

## Connection

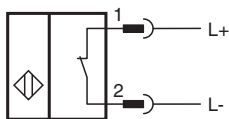

## Connection Assignment

