



## Model Number

NCN4-12GM60-B3B-C2-V1

## Features

- 4 mm non-flush
- AS-Interface
- A/B slave with extended addressing possibility for up to 62 slaves
- NO/NC selectable
- On/Off delay (disconnectable)

## Accessories

### BF 12

Mounting flange, 12 mm

### V1-G

Female connector, M12, 4-pin, field attachable

### EXG-12

Quick mounting bracket with dead stop

### V1-W

Female connector, M12, 4-pin, field attachable

### V1-W-2M-PUR

Female cordset, M12, 4-pin, PUR cable

### V1-G-2M-PUR

Female cordset, M12, 4-pin, PUR cable

## Technical Data

### General specifications

Switching function		Normally open/closed (NO/NC) programmable
Output type		AS-Interface
Rated operating distance	$s_n$	4 mm
Installation		non-flush
Assured operating distance	$s_a$	0 ... 3.24 mm
Actual operating distance	$s_r$	3.6 ... 4.4 mm typ. 4 mm
Reduction factor $r_{AI}$		0.37
Reduction factor $r_{CU}$		0.36
Reduction factor $r_{304}$		0.74
Output type		2-wire

### Nominal ratings

Operating voltage	$U_B$	26.5 ... 31.9 V via AS-i bus system
Switching frequency	$f$	0 ... 500 Hz
Hysteresis	$H$	1 ... 15 typ. 5 %
Reverse polarity protection		reverse polarity protected
Time delay before availability	$t_v$	≤ 1000 ms
Alternating magnetic field	$B$	100 mT
Switching state indicator		dual-LED, yellow
Error indicator		dual-LED, red

### Ambient conditions

Ambient temperature		-25 ... 70 °C (-13 ... 158 °F)
Storage temperature		-40 ... 85 °C (-40 ... 185 °F)

### Mechanical specifications

Connection type		Connector plug M12 x 1, 4-pin
Housing material		Stainless steel
Sensing face		PBT
Degree of protection		IP67

### Compliance with standards and directives

Standard conformity		
Standards		EN 60947-5-2:2007 IEC 60947-5-2:2007

### Approvals and certificates

UL approval		cULus Listed, General Purpose
CSA approval		cCSAus Listed, General Purpose
CCC approval		CCC approval / marking not required for products rated ≤36 V

## Dimensions

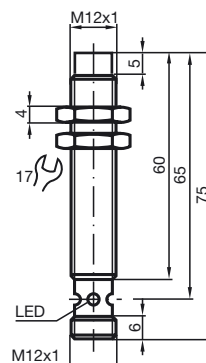

## Electrical Connection

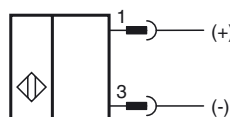

Wire colors in accordance with EN 60947-5-2

1	BN	(brown)
2	WH	(white)
3	BU	(blue)
4	BK	(black)

Programming Instructions

Address 00 preset, alterable via Busmaster or programming units  
 IO-Code 0  
 ID-Code A  
 ID1-Code 7  
 ID2-Code E

Data bit

Bit	Function
D0	Switching state
D1	not used
D2	not used
D3	not used

Parameter bit

Bit	Function
P0	ON / Off delay activated* / deactivated
P1	Switching element function NO* / NC
P2	not used
P3	not used

\*Standard setting

On/off delay:

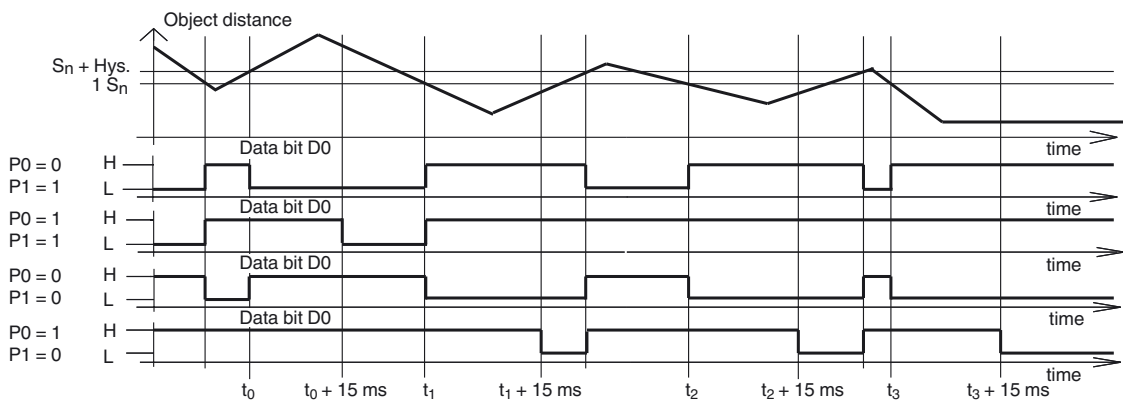

The on/off delay is preset and switched on (P0=1). On delay approx.15 ms, when P0=1 and NO function (P1=1). Off delay approx.15 ms, when P0=1 and NC function (P1=0).

Release date: 2019-08-23 12:42 Date of issue: 2019-08-23 800556\_eng.xml