

Inductive sensor

NBB5-18GM40-Z0-5M

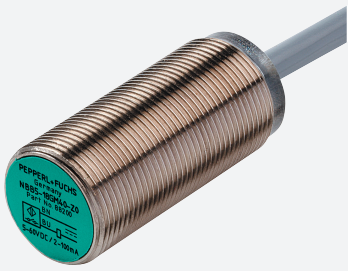

- 5 mm flush
- 2-wire DC



Dimensions

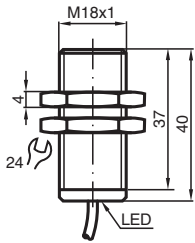

Technical Data

General specifications			
Rated operating distance	s_n		5 mm
Installation			flush
Output polarity			DC
Assured operating distance	s_a		0 ... 4.05 mm
Actual operating distance	s_r		4.5 ... 5.5 mm typ. 5 mm
Reduction factor r_{Al}			0.34
Reduction factor r_{Cu}			0.31
Reduction factor r_{304}			0.72
Output type			2-wire
Nominal ratings			
Operating voltage	U_B		5 ... 60 V
Switching frequency	f		0 ... 500 Hz
Hysteresis	H		1 ... 10 typ. 5 %
Reverse polarity protection			reverse polarity tolerant
Short-circuit protection			pulsing
Voltage drop	U_d		≤ 5 V

Release date: 2023-12-13 Date of issue: 2023-12-13 Filename: 800929_eng.pdf

Refer to "General Notes Relating to Pepperl+Fuchs Product Information".

Pepperl+Fuchs Group
www.pepperl-fuchs.com

USA: +1 330 486 0001
fa-info@us.pepperl-fuchs.com

Germany: +49 621 776 1111
fa-info@de.pepperl-fuchs.com

Singapore: +65 6779 9091
fa-info@sg.pepperl-fuchs.com

 **PEPPERL+FUCHS**

Technical Data

Operating current	I_L	2 ... 100 mA
Lowest operating current	I_m	2 mA
Off-state current	I_r	0 ... 0.5 mA typ.
Switching state indicator		all direction LED, yellow
Functional safety related parameters		
MTTF _d		1870 a
Mission Time (T _M)		20 a
Diagnostic Coverage (DC)		0 %
Compliance with standards and directives		
Standard conformity		
Standards		EN 60947-5-2:2007 EN 60947-5-2/A1:2012 IEC 60947-5-2:2007 IEC 60947-5-2 AMD 1:2012
Approvals and certificates		
UL approval		cULus Listed, General Purpose
CCC approval		Certified by China Compulsory Certification (CCC)
Ambient conditions		
Ambient temperature		-25 ... 70 °C (-13 ... 158 °F)
Mechanical specifications		
Connection type		cable PVC , 5 m
Core cross section		0.34 mm ²
Housing material		brass, nickel-plated
Sensing face		PBT
Degree of protection		IP67
Cable		
Cable diameter		4.8 mm ± 0.2 mm
Bending radius		> 10 x cable diameter

Connection

