

Inductive sensor

NCB1,5-18GM60-E2-D-Y803668



- 1.5 mm flush
- Compression proof up to 350 bar, dynamic on active surface
- For applications in hydraulic cylinder



Dimensions

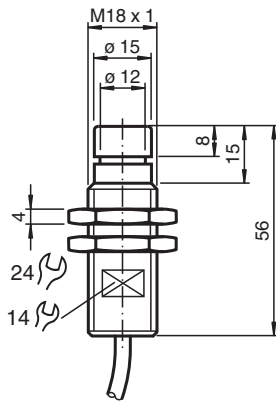

Technical Data

General specifications

Switching function		Normally open (NO)
Output type		PNP
Rated operating distance	s_n	1.5 mm
Installation		flush
Output polarity		DC
Assured operating distance	s_a	0 ... 1.22 mm
Reduction factor r_{304}		0.5
Output type		3-wire

Nominal ratings

Operating voltage	U_B	10 ... 60 V DC
Switching frequency	f	0 ... 1500 Hz
Hysteresis	H	typ. 5 %
Reverse polarity protection		reverse polarity protected
Short-circuit protection		pulsing
Voltage drop	U_d	≤ 2.5 V
Operating current	I_L	0 ... 200 mA
No-load supply current	I_0	≤ 10 mA

Limit data

Release date: 2024-01-16 Date of issue: 2024-01-16 Filename: 803668_eng.pdf

Refer to "General Notes Relating to Pepperl+Fuchs Product Information".

Pepperl+Fuchs Group
www.pepperl-fuchs.com

USA: +1 330 486 0001
fa-info@us.pepperl-fuchs.com

Germany: +49 621 776 1111
fa-info@de.pepperl-fuchs.com

Singapore: +65 6779 9091
fa-info@sg.pepperl-fuchs.com

PF PEPPERL+FUCHS

Technical Data

Operating pressure	350 bar (5076.4 psi)	
Functional safety related parameters		
MTTF _d	1240 a	
Mission Time (T _M)	20 a	
Diagnostic Coverage (DC)	0 %	
Compliance with standards and directives		
Standard conformity		
Standards	EN 60947-5-2:2007 EN 60947-5-2/A1:2012 IEC 60947-5-2:2007 IEC 60947-5-2 AMD 1:2012	
Approvals and certificates		
UL approval	cULus Listed, General Purpose	
CCC approval	Certified by China Compulsory Certification (CCC)	
Ambient conditions		
Ambient temperature	-35 ... 80 °C (-31 ... 176 °F)	
Mechanical specifications		
Connection type	cable	
Housing material	Stainless steel 1.4305 / AISI 303	
Sensing face	Epoxy (black)	
Degree of protection	IP67	
Cable		
Wire end ferrules	yes	
Cable diameter	4.6 mm ± 0.2 mm	
Bending radius	> 10 x cable diameter	
Material	PVC	
Color	grey	
Number of cores	3	
Core cross section	0.34 mm ²	
Length	L	2 m
Mass	140 g	
Dimensions		
Length	56 mm	
Diameter	18 mm	

Connection

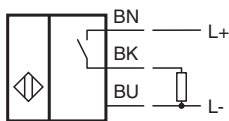

Release date: 2024-01-16 Date of issue: 2024-01-16 Filename: 803668_eng.pdf

Refer to "General Notes Relating to Pepperl+Fuchs Product Information".

Pepperl+Fuchs Group
www.pepperl-fuchs.com

USA: +1 330 486 0001
fa-info@us.pepperl-fuchs.com

Germany: +49 621 776 1111
fa-info@de.pepperl-fuchs.com

Singapore: +65 6779 9091
fa-info@sg.pepperl-fuchs.com

 **PEPPERL+FUCHS**

Installation

Note

Please refer to the technical information about this product at www.pepperl-fuchs.com. This information describes the necessary geometry of the installation space!

Release date: 2024-01-16 Date of issue: 2024-01-16 Filename: 803668_eng.pdf

Refer to "General Notes Relating to Pepperl+Fuchs Product Information".

Pepperl+Fuchs Group
www.pepperl-fuchs.com

USA: +1 330 486 0001
fa-info@us.pepperl-fuchs.com

Germany: +49 621 776 1111
fa-info@de.pepperl-fuchs.com

Singapore: +65 6779 9091
fa-info@sg.pepperl-fuchs.com

 **PEPPERL+FUCHS**