

Active surface metal  
 2 mm embeddable  
 Resistant to welding

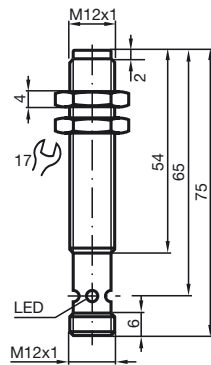

General specifications	
Switching element function	PNP Make function
Rated operating distance $s_n$	2 mm
Installation	embed. in mild steel
Assured operating distance $s_a$	0 ... 1.62 mm
Reduction factor $r_{Al}$	0
Reduction factor $r_{Cu}$	0
Reduction factor $r_{V2A}$	0.8
Reduction factor $r_{St37}$	1
Nominal ratings	
Operating voltage $U_B$	10 ... 30 V
Switching frequency $f$	0 ... 100 Hz
Hysteresis $H$	3 ... 15 typ. 5 %
Reverse polarity protection	Protected against reverse polarity
Short-circuit protection	pulsing
Voltage drop $U_d$	$\leq 2$ V
Operating current $I_L$	0 ... 200 mA
Off-state current $I_r$	0 ... 10 $\mu$ A typ. 0.1 $\mu$ A at 25 °C
No-load supply current $I_0$	$\leq 10$ mA
Constant magnetic field $B$	50 mT
Alternating magnetic field $B$	50 mT
Indication of the switching state	LED, yellow
Standard conformity	
Standards	IEC / EN 60947-5-2:2004
Ambient conditions	
Ambient temperature	-25 ... 70 °C (248 ... 343 K)
Mechanical specifications	
Connection type	V1-connector
Housing material	Stainless steel
Sensing face	Stainless steel
Protection degree	IP67

### Connection type:

