

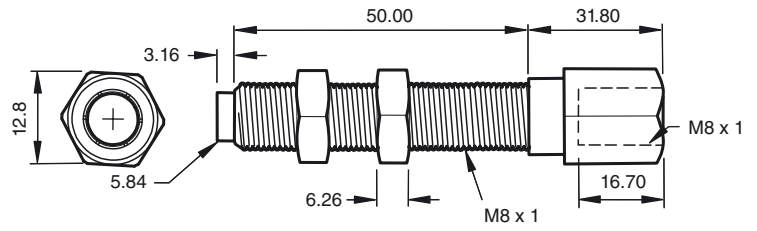

Dimensions



Technical data

Mechanical specifications

Material Heat-treated alloy steel

Model Number

ES-08-50

Mounting adapter

Features

- End stop adapter
- For 8 mm diameter sensors

Application

The end stop adapter turns a standard 8 mm diameter shielded inductive sensor into a durable mechanical stop switch. These adapters are useful for applications where end-of-travel signals are required. Sensor activation point is dependent upon the insertion depth (0 - 1.5 mm).

Release date: 2011-09-23 20:04 Date of issue: 2011-09-23 904109_eng.xml

Subject to modifications without notice

Pepperl+Fuchs Group
www.pepperl-fuchs.com

USA: +1 330 486 0001
fa-info@us.pepperl-fuchs.com

Germany: +49 621 776-4411
fa-info@pepperl-fuchs.com

Copyright Pepperl+Fuchs

Singapore: +65 6779 9091
fa-info@sg.pepperl-fuchs.com