

Inductive sensor

NBN15-30GK60-UR-1M



- Relay output
- Sensing range 15 mm
- SPDT output
- AC/DC Model
- Switch load currents to 6 Amps



Dimensions

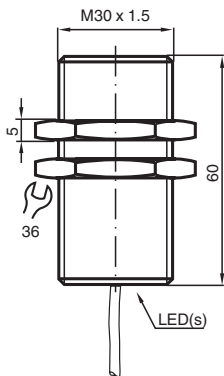

Technical Data

General specifications		
Switching function		change-over contact
Output type		relay
Rated operating distance	S_n	15 mm
Installation		non-flush
Output polarity		DC
Reduction factor r_{Al}		0.4
Reduction factor r_{Cu}		0.37
Reduction factor r_{304}		0.73
Output type		Relay output
Mechanical life		No load: 2×10^7 operations Full load: 1×10^5 switching cycles
Nominal ratings		
Hysteresis	H	1 ... 12 %
Reverse polarity protection		reverse polarity tolerant
Short-circuit protection		no
Rated operating current	I_e	< 50 mA AC/DC
Switching state indicator		LED, red 360°

Release date: 2023-10-18 Date of issue: 2023-10-18 Filename: 904971_eng.pdf

Refer to "General Notes Relating to Pepperl+Fuchs Product Information".

Pepperl+Fuchs Group
www.pepperl-fuchs.com

USA: +1 330 486 0001
fa-info@us.pepperl-fuchs.com

Germany: +49 621 776 1111
fa-info@de.pepperl-fuchs.com

Singapore: +65 6779 9091
fa-info@sg.pepperl-fuchs.com

 PEPPERL+FUCHS



Technical Data

Electrical specifications		
Rated operating voltage	U _e	20 ... 132 V AC/DC
Output		
Switching voltage		max 28 V DC , 250 V AC
Switching current		6 A , AC/DC, resistive load
Switching power		max 180 W
Compliance with standards and directives		
Standard conformity		
Standards		EN 60947-5-2:2007 IEC 60947-5-2:2007
Approvals and certificates		
UL approval		cULus Listed, General Purpose
CSA approval		cCSAus Listed, General Purpose
Ambient conditions		
Ambient temperature		-40 ... 70 °C (-40 ... 158 °F)
Mechanical specifications		
Connection type		1-meter cable, PVC heavy jacket, 5-conductor, #18 AWG
Core cross section		0.75 mm ²
Housing material		PBT
Sensing face		PBT
Degree of protection		IP68

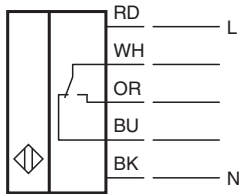
Connection



Accessories

	BF 30	Mounting flange, 30 mm
	AB-30	Mounting aid

Release date: 2023-10-18 Date of issue: 2023-10-18 Filename: 904971_eng.pdf