

Stopping Plugs, Metal, Hexagon Head

SP.MD.*.*.*

- Stopping plug for unused cable entries
- Brass nickel-plated or stainless steel
- Metric and NPT versions available
- Hexagon head
- Ex db, Ex eb and Ex tb certified
- Seal chloroprene or silicone
- Suitable for operation in Zone 1, Zone 2, Zone 21 and Zone 22
- Suitable for operation in Class I, Zone 1/2/22
- Suitable for operation in Class I, Division 2 when installed in accordance with NEC501.10(B)(2)
- Degree of protection IP66 / IP68, UL Type 4X



Additional Information

The metal stopping plugs type SP.MD* are suitable for safely closing openings and holes for cable entries that are not used in enclosures certified according to type of protection Ex eb or Ex tb. Metric versions can be used with Ex db enclosures, too.

Technical Data

Mechanical specifications

Thread type	metric ISO pitch 1.5 mm or NPT ANSI ASME B1.20.1
Thread size (TD)	see data table
Degree of protection	IP66 / IP68 , UL Type 4X
Material	
Finish	inherent color silver
Washer gasket	aramid fibers bonded with NBR
O-Ring	chloroprene / neoprene or silicone
Stopping plug	brass nickel-plated or AISI 316 (1.4401) stainless steel
Mass	see data table
Dimensions	see data table

Ambient conditions

Ambient temperature	chloroprene seal: -40 ... 100 °C (-40 ... 212 °F) silicone seal: -60 ... 130 °C (-76 ... 266 °F) washer gasket: -40 ... 80 °C (-40 ... 176 °F)
---------------------	--

Data for application in connection with hazardous areas

EU-type examination certificate	CESI 15 ATEX 029X
Marking	Ex II 2 GD Ex db IIC Gb Ex eb IIC Gb Ex tb IIIC Db

International approvals

UL approval	
cULus	E305142 tested to UL 50E and UL 508A
CSA approval	CSA C22.2, No. 14-13
IECEx approval	IECEx CES 15.0006X
UKCA approval	CML 22 UKEX 1267X
EAC approval	RU C-DE.AA87.B.00459/20
CCC approval	2021312313000343

Conformity

Release date: 2022-06-04 Date of issue: 2022-06-04 Filename: t176941_engg.pdf

Refer to "General Notes Relating to Pepperl+Fuchs Product Information".

Pepperl+Fuchs Group
www.pepperl-fuchs.com

USA: +1 330 486 0002
pa-info@us.pepperl-fuchs.com

Germany: +49 621 776 2222
pa-info@de.pepperl-fuchs.com

Singapore: +65 6779 9091
pa-info@sg.pepperl-fuchs.com

PEPPERL+FUCHS

Technical Data

Degree of protection	EN 60529
CE marking	0102
General information	
Scope of delivery	K01 - metric variants, individual component: Stopping Plug , washer gasket , locknut , brief instructions K01 - NPT variants, individual component: Stopping Plug , brief instructions Knn - packing unit with multiple components: Stopping Plugs , brief instructions (1 copy)
Supplementary information	EC-Type Examination Certificate, Statement of Conformity, Declaration of Conformity, Attestation of Conformity and instructions have to be observed where applicable. For information see www.pepperl-fuchs.com.

Type Code

1	2	3	4	5	6	7
SP	MD	***	**	*	**	K**
SP	MD	M20	BN	C	15	K01

Example: SP.MD.M20.BN.C.15.K01

Stopping plug, metal, hexagon head, thread size M20, body brass nickel-plated, chloropren O-ring for -40 °C ... 100 °C, installation thread length 15 mm, one piece

1	Series
SP	Stopping plug
2	Type
MD	metal, hexagon head
3	Thread, type and size
M*	metric ISO pitch 1.5; sizes see dimensions data table
NPT*	NPT ANSI ASME B1.20.1; sizes see dimensions data table
4	Material
BN	brass nickel-plated
SS	stainless steel
5	Material seals / O-Ring
C	chloroprene / neoprene
S	silicone
X	no seal
6	Thread length for installation in enclosure
**	length in mm
7	Packaging unit
	units not packaged, for use in Pepperl+Fuchs Solution Engineering Centers
K**	units quantity per package

Release date: 2022-06-04 Date of issue: 2022-06-04 Filename: t176941_eng.pdf

Dimensions

Legend	
1	Washer gasket (accessory, metric versions only)
2	O-Ring (metric versions only)
3	Stopping plug
L	Total length
SW*	Width across flats
TD	Thread size
TL	Thread length

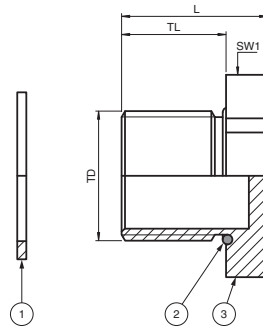

Release date: 2022-06-04 Date of issue: 2022-06-04 Filename: t176941_eng.pdf

Refer to "General Notes Relating to Pepperl+Fuchs Product Information".

Dimensions Metric - Brass Nickel-plated, O-Ring Chloroprene

Type	Thread size	Dimensions [mm]			Mass approx.		Diameter thru-hole [mm]	Nut torques [Nm]		Delivery quantity
	TD	L	TL	SW1	Component	Packaging unit	TD	SW1		
SP.MD.M16..C.15.K01	M16	21	15.5	22	29 g	38 g	16 ... 16.2	4	1	
SP.MD.M16.BN.C.15.K50	M16	21	15.5	22	29 g	1.6 kg	16 ... 16.2	4	50	
SP.MD.M20.BN.C.15.K01	M20	21	15.5	25	36 g	52 g	20 ... 20.2	6	1	
SP.MD.M20.BNBN.C.15.K50	M20	21	15.5	25	36 g	1.98 g	20 ... 20.2	6	50	
SP.MD.M25.BN.C.15.K01	M25	21	15.5	30	49 g	68 g	25 ... 25.2	8.5	1	
SP.MD.M25.BN.C.15.K50	M25	21	15.5	30	49 g	2.7 g	25 ... 25.2	8.5	50	
SP.MD.M32.BN.C.15.K01	M32	21	15.5	37	69 g	93 g	32 ... 32.3	9	1	
SP.MD.M32.BN.C.15.K25	M32	21	15.5	37	69 g	1.9 kg	32 ... 32.3	9	25	
SP.MD.M40.BN.C.17.K01	M40	23	17.5	45	106 g	140 g	40 ... 40.3	9.5	1	
SP.MD.M40.BN.C.17.K10	M40	23	17.5	45	106 g	1.17 kg	40 ... 40.3	9.5	10	
SP.MD.M50.BN.C.17.K01	M50	23	17.5	55	148 g	217 g	50 ... 50.3	10	1	
SP.MD.M50.BN.C.17.K05	M50	23	17.5	55	148 g	810 g	50 ... 50.3	10	5	
SP.MD.M63.BN.C.17.K01	M63	23	17.5	70	313 g	423 g	63 ... 63.3	10.5	1	
SP.MD.M63.BN.C.17.K05	M63	23	17.5	70	313 g	1.72 kg	63 ... 63.3	10.5	5	

*Knn: scope of delivery see table technical data

Dimensions Metric - Stainless Steel, O-Ring Chloroprene

Type	Thread size	Dimensions [mm]			Mass approx.		Diameter thru-hole [mm]	Nut torques [Nm]		Delivery quantity
	TD	L	TL	SW1	Component	Packaging unit	TD	SW1		
SP.MD.M16.SS.C.15.K01	M16	21	15.5	22	29 g	39 g	16 ... 16.2	4	1	
SP.MD.M16.SS.C.15.K50	M16	21	15.5	22	29 g	1.58 kg	16 ... 16.2	4	50	
SP.MD.M20.SS.C.15.K01	M20	21	15.5	25	34 g	46 g	20 ... 20.2	6	1	
SP.MD.M20.SS.C.15.K50	M20	21	15.5	25	34 g	1.87 kg	20 ... 20.2	6	50	
SP.MD.M25.SS.C.15.K01	M25	21	15.5	30	51 g	69 g	25 ... 25.2	8.5	1	
SP.MD.M25.SS.C.15.K50	M25	21	15.5	30	51 g	2.81 kg	25 ... 25.2	8.5	50	
SP.MD.M32.SS.C.15.K01	M32	21	15.5	37	67 g	90 g	32 ... 32.3	9	1	
SP.MD.M32.SS.C.15.K25	M32	21	15.5	37	67 g	1.84 kg	32 ... 32.3	9	25	
SP.MD.M40.SS.C.17.K01	M40	23	17.5	45	105 g	142 g	40 ... 40.3	9.5	1	
SP.MD.M40.SS.C.17.K10	M40	23	17.5	45	105 g	1.16 kg	40 ... 40.3	9.5	10	
SP.MD.M50.SS.C.17.K01	M50	23	17.5	55	151 g	197 g	50 ... 50.3	10	1	
SP.MD.M50.SS.C.17.K05	M50	23	17.5	55	151 g	830 g	50 ... 50.3	10	5	
SP.MD.M63.SS.C.17.K01	M63	23	17.5	70	287 g	387 g	63 ... 63.3	10.5	1	
SP.MD.M63.SS.C.17.K05	M63	23	17.5	70	287 g	1.58 kg	63 ... 63.3	10.5	5	

*Knn: scope of delivery see table technical data

Release date: 2022-06-04 Date of issue: 2022-06-04 Filename: t176941_eng.pdf

Refer to "General Notes Relating to Pepperl+Fuchs Product Information".

Dimensions NPT - Brass Nickel-plated

Type	Thread size	Dimensions [mm]			Mass approx.		Diameter thru-hole [mm]	Nut torques [Nm]		Delivery quantity
	TD	L	TL	SW1	Component	Packaging unit	TD	SW1		
SP.MD.NPT3/8.BN.X.16.K01	NPT 3/8"	20	16	20	24 g	34 g	17.2 ... 17.4	7	1	
SP.MD.NPT3/8.BN.X.16.K50	NPT 3/8"	20	16	20	24 g	1.32 kg	17.2 ... 17.4	7	50	
SP.MD.NPT1/2.BN.X.18.K01	NPT 1/2"	22	18	24	44 g	54 g	21.4 ... 21.6	8	1	
SP.MD.NPT1/2.BN.X.18.K50	NPT 1/2"	22	18	24	44 g	2.42 kg	21.4 ... 21.6	8	50	
SP.MD.NPT3/4.BN.X.18.K01	NPT 3/4"	22	18	28	62 g	72 g	26.7 ... 26.9	9	1	
SP.MD.NPT3/4.BN.X.18.K50	NPT 3/4"	22	18	28	62 g	3.41 kg	26.7 ... 26.9	9	50	
SP.MD.NPT1.BN.X.21.K01	NPT 1"	25	21	35	92 g	102 g	33.5 ... 33.7	11	1	
SP.MD.NPT1.BN.X.21.K25	NPT 1"	25	21	35	92 g	2.53 kg	33.5 ... 33.7	11	25	
SP.MD.NPT1-1/4.BN.X.21.K01	NPT 1-1/4"	25	21	45	129 g	139 g	42.2 ... 42.4	13	1	
SP.MD.NPT1-1/4.BN.X.21.K10	NPT 1-1/4"	25	21	45	129 g	1.42 kg	42.2 ... 42.4	13	10	
SP.MD.NPT1-1/2.BN.X.21.K01	NPT 1-1/2"	26	21	50	177 g	187 g	48.3 ... 48.5	15	1	
SP.MD.NPT1-1/2.BN.X.21.K05	NPT 1-1/2"	26	21	50	177 g	970 g	48.3 ... 48.5	15	5	
SP.MD.NPT2.BN.X.21.K01	NPT 2"	26	21	65	274 g	284 g	60.4 ... 60.7	18	1	
SP.MD.NPT2.BN.X.21.K05	NPT 2"	26	21	65	274 g	1.51 kg	60.4 ... 60.7	18	5	

*Knn: scope of delivery see table technical data

Dimensions NPT - Stainless Steel

Type	Thread size	Dimensions [mm]			Mass approx.		Diameter thru-hole [mm]	Nut torques [Nm]		Delivery quantity
	TD	L	TL	SW1	Component	Packaging unit	TD	SW1		
SP.MD.NPT3/8.SS.X.16.K01	NPT 3/8"	20	16	20	22 g	32 g	17.2 ... 17.4	7	1	
SP.MD.NPT3/8.SS.X.16.K50	NPT 3/8"	20	16	20	22 g	1.21 kg	17.2 ... 17.4	7	50	
SP.MD.NPT1/2.SS.X.18.K01	NPT 1/2"	22	18	24	42 g	46 g	21.4 ... 21.6	8	1	
SP.MD.NPT1/2.SS.X.18.K50	NPT 1/2"	22	18	24	42 g	2.31 kg	21.4 ... 21.6	8	50	
SP.MD.NPT3/4.SS.X.18.K01	NPT 3/4"	22	18	28	59 g	61 g	26.7 ... 26.9	9	1	
SP.MD.NPT3/4.SS.X.18.K50	NPT 3/4"	22	18	28	59 g	3.25 kg	26.7 ... 26.9	9	50	
SP.MD.NPT1.SS.X.21.K01	NPT 1"	25	21	35	87 g	97 g	33.5 ... 33.7	11	1	
SP.MD.NPT1.SS.X.21.K25	NPT 1"	25	21	35	87 g	2.39 kg	33.5 ... 33.7	11	25	
SP.MD.NPT1-1/4.SS.X.21.K01	NPT 1-1/4"	25	21	45	122 g	132 g	42.2 ... 42.4	13	1	
SP.MD.NPT1-1/4.SS.X.21.K10	NPT 1-1/4"	25	21	45	122 g	1.34 kg	42.2 ... 42.4	13	10	
SP.MD.NPT1-1/2.SS.X.21.K01	NPT 1-1/2"	26	21	50	168 g	178 g	48.3 ... 48.5	15	1	
SP.MD.NPT1-1/2.SS.X.21.K05	NPT 1-1/2"	26	21	50	168 g	920 g	48.3 ... 48.5	15	5	
SP.MD.NPT2.SS.X.21.K01	NPT 2"	26	21	65	260 g	270 g	60.4 ... 60.7	18	1	
SP.MD.NPT2.SS.X.21.K05	NPT 2"	26	21	65	260 g	1.43 kg	60.4 ... 60.7	18	5	

*Knn: scope of delivery see table technical data

Release date: 2022-06-04 Date of issue: 2022-06-04 Filename: t176941_eng.pdf