



Cable Glands, Metal, Barrier Glands for non-armored Cables

CG.BN.*.*.*

- For cables without armor
- Barrier gland
- Brass nickel-plated or stainless steel
- Metric and NPT versions available
- Seal silicone
- Ex db, Ex eb and Ex tb certified
- Suitable for operation in Zone 1, Zone 2, Zone 21 and Zone 22



Function

The metal cable glands type CG.BN are suitable for indoor and outdoor applications in Zone 1, Zone 2, Zone 21 and Zone 22 hazardous areas. They are intended for use with cables without armor. A two-part system sealing compound provides a reliable protection against explosion transmission through the cables.

Technical Data

Mechanical specifications	
Cable type	non-armored cables
Clamping range (D)	see data table
Thread type	metric ISO pitch 1.5 mm or NPT ANSI ASME B1.20.1
Thread size (TD)	see data table
Degree of protection	IP66 / IP68
Material	
Finish	inherent color silver
Cable gland	brass nickel-plated or AISI 316 (1.4401) stainless steel
O-Ring	silicone
Seal insert	silicone
Mass	see data table
Dimensions	see data table
Ambient conditions	
Ambient temperature	-60 ... 100 °C (-76 ... 212 °F)
Data for application in connection with hazardous areas	
EU-type examination certificate	CESI 18 ATEX 037X
Marking	Ⓜ II 2 GD Ex db IIC Gb Ex eb IIC Gb Ex tb IIIC Db
International approvals	
IECEX approval	IECEX CES 18.0030X
UKCA approval	CML 22 UKEX 1268X
CCC approval	2021312313000456
Conformity	
Degree of protection	EN 60529
CE marking	0102
General information	

Release date: 2023-09-01 Date of issue: 2023-09-01 Filename: t190579_eng.pdf

Refer to "General Notes Relating to Pepperl+Fuchs Product Information".

Pepperl+Fuchs Group
www.pepperl-fuchs.com

USA: +1 330 486 0002
pa-info@us.pepperl-fuchs.com

Germany: +49 621 776 2222
pa-info@de.pepperl-fuchs.com

Singapore: +65 6779 9091
pa-info@sg.pepperl-fuchs.com

PF PEPPERL+FUCHS

Technical Data

Scope of delivery	K01 - individual component: Cable gland , epoxy moulding compound , pair of gloves , Brief instructions Knn - packing unit with multiple components: Cable glands , epoxy moulding compound , pair of gloves , Brief instructions (1 copy)
Supplementary information	EC-Type Examination Certificate, Statement of Conformity, Declaration of Conformity, Attestation of Conformity and instructions have to be observed where applicable. For information see www.pepperl-fuchs.com .

Type Code

1	2	3	4	5	6	7
CG	BN	***	**	*	**	K**
CG	BN	M20	BN	S	16	K01

Example: CG.BN.M20.BN.S.16.K01

Barrier gland metal, for non-armored cables, thread size M20, body brass nickel-plated, silicone seals for -60 °C ... 100 °C, installation thread length 16 mm, one piece

1	Series
CG	cable glands
2	Type
BN	metal barrier glands for non-armored cables
3	Thread, type and size
M*	metric ISO pitch 1.5; sizes see dimensions data table
NPT*	NPT ANSI ASME B1.20.1; sizes see dimensions data table
4	Material
BN	brass nickel-plated
SS	stainless steel
5	Material seals / O-Ring
S	silicone
6	Thread length for installation in enclosure
**	length in mm
7	Packaging unit
	units not packaged, for use in Pepperl+Fuchs Solution Engineering Centers
K**	units quantity per package

Dimensions

Legend	
1	Gland body basis
2	O-Ring
3	Barrier tube
6	Gland body
7	Seal insert
8	Pressure nut
9	Barrier pressure ring bushing
D	Clamping range, cable sheath diameter
D2	Width across corners
H	Length outside enclosure
L	Total length
SW*	Width across flats
TD	Thread size
TL	Thread length
Barrier Details in data table	
CQ	Max. number of cores
DS	Core cross-section, single-core cable
DM	Core cross-section, multi-core cable
CC	Max. total core cross-section area

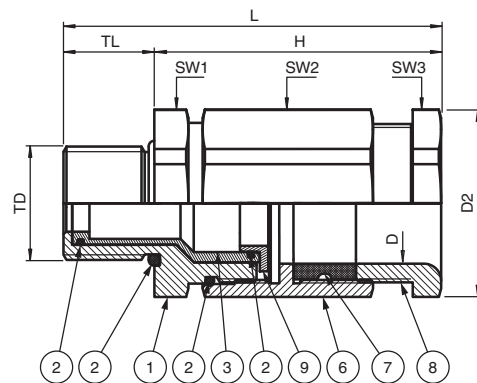
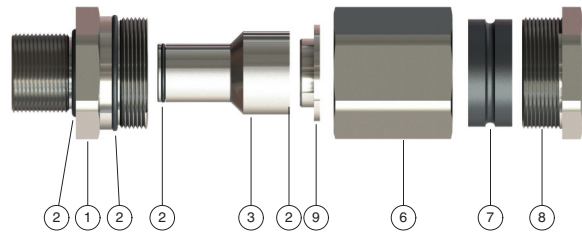

Dimensions Metric - Brass Nickel-plated

Type	Thread size	Clamping range [mm]	Dimensions [mm]						
			TD	D	H	L	TL	D2	SW1
CG.BN.M20S.BN.S.16.*	M20	6 ... 13	49.2	65.2	16	27	25	25	25
CG.BN.M20L.BN.S.16.*	M20	8 ... 15	49.2	65.2	16	27	25	25	25
CG.BN.M20L.BN.S.16.*	M20	13.5 ... 21	50.5	66.5	16	33	30	30	30
CG.BN.M25S.BN.S.16.*	M25	8 ... 15	49.2	65.2	16	33	30	25	25
CG.BN.M25L.BN.S.16.*	M25	13.5 ... 21	50.5	66.5	16	33	30	30	30
CG.BN.M25L.BN.S.16.*	M25	18 ... 27	57.9	73.9	16	44.5	40	40	40
CG.BN.M32L.BN.S.16.*	M32	18 ... 27	57.9	73.9	16	44.5	40	40	40
CG.BN.M32L.BN.S.16.*	M32	23 ... 33	59.7	75.7	16	47	43	43	43
CG.BN.M40S.BN.S.16.*	M40	23 ... 33	59.7	75.7	16	50	45	43	43
CG.BN.M40L.BN.S.16.*	M40	29 ... 40	67.5	83.5	16	55.5	50	50	50
CG.BN.M50S.BN.S.16.*	M50	29 ... 40	67.5	83.5	16	61	55	50	50
CG.BN.M50L.BN.S.16.*	M50	35 ... 48	73.2	89.2	16	64	58	58	58
CG.BN.M63S.BN.S.20.*	M63	35 ... 48	73.2	89.2	16	75	68	58	58
CG.BN.M63L.BN.S.20.*	M63	42 ... 56	95.5	115.5	20	83	75	75	75
CG.BN.M75S.BN.S.20.*	M75	42 ... 56	95.5	115.5	20	89	80	75	75
CG.BN.M75L.BN.S.20.*	M75	54 ... 70	104.5	124.5	20	110.5	100	100	100

Release date: 2023-09-01 Date of issue: 2023-09-01 Filename: t190579_eng.pdf

Refer to "General Notes Relating to Pepperl+Fuchs Product Information".

Details and Accessories Metric - Brass Nickel-plated

Type	Thread size	Mass approx.		Barrier details				Nut torques [Nm]			Delivery quantity
	TD	Component	Packaging unit	CQ max. qty.	DS [mm]	DM [mm]	CC max. [mm ²]	SW 1	SW 2	SW 3	
CG.BN.M20S.BN.S.16.K01	M20	153 g	210 g	9	1.5 ... 9.5	1.5 ... 9.5	70.9	60	60	30	1
CG.BN.M20S.BN.S.16.K15	M20	153 g	3.1 kg	9	1.5 ... 9.5	1.5 ... 9.5	70.9	60	60	30	15
CG.BN.M20.BN.S.16.K01	M20	147 g	204 g	9	1.5 ... 9.5	1.5 ... 9.5	70.9	60	60	25	1
CG.BN.M20.BN.S.16.K15	M20	147 g	3.01 kg	9	1.5 ... 9.5	1.5 ... 9.5	70.9	60	60	25	15
CG.BN.M20L.BN.S.16.K01	M20	186 g	243 g	9	1.5 ... 9.5	1.5 ... 9.5	70.9	60	60	35	1
CG.BN.M20L.BN.S.16.K15	M20	186 g	3.6 kg	9	1.5 ... 9.5	1.5 ... 9.5	70.9	60	60	35	15
CG.BN.M25S.BN.S.16.K01	M25	184 g	241 g	9	1.5 ... 9.5	1.5 ... 9.5	70.9	60	60	25	1
CG.BN.M25S.BN.S.16.K10	M25	184 g	2.46 kg	9	1.5 ... 9.5	1.5 ... 9.5	70.9	60	60	25	10
CG.BN.M25.BN.S.16.K01	M25	209 g	266 g	9	1.5 ... 9.5	1.5 ... 9.5	70.9	65	65	35	1
CG.BN.M25.BN.S.16.K10	M25	209 g	2.71 kg	9	1.5 ... 9.5	1.5 ... 9.5	70.9	65	65	35	10
CG.BN.M25L.BN.S.16.K01	M25	371 g	428 g	22	1.5 ... 15	1.5 ... 15	176.7	65	65	30	1
CG.BN.M25L.BN.S.16.K10	M25	371 g	4.33 kg	22	1.5 ... 15	1.5 ... 15	176.7	65	65	30	10
CG.BN.M32.BN.S.16.K01	M32	413 g	470 g	22	1.5 ... 15	1.5 ... 15	176.7	70	70	30	1
CG.BN.M32.BN.S.16.K10	M32	413 g	4.75 kg	22	1.5 ... 15	1.5 ... 15	176.7	70	70	30	10
CG.BN.M32L.BN.S.16.K01	M32	372 g	454 g	36	1.5 ... 21.5	1.5 ... 21.5	363.1	70	70	55	1
CG.BN.M32L.BN.S.16.K10	M32	372 g	4.59 kg	36	1.5 ... 21.5	1.5 ... 21.5	363.1	70	70	55	10
CG.BN.M40S.BN.S.16.K01	M40	441 g	528 g	36	1.5 ... 21.5	1.5 ... 21.5	363.1	80	70	55	1
CG.BN.M40S.BN.S.16.K05	M40	441 g	2.76 kg	36	1.5 ... 21.5	1.5 ... 21.5	363.1	80	70	55	5
CG.BN.M40.BN.S.16.K01	M40	496 g	608 g	55	1.5 ... 29	1.5 ... 29	660.5	80	80	65	1
CG.BN.M40.BN.S.16.K05	M40	469 g	3.17 kg	55	1.5 ... 29	1.5 ... 29	660.5	80	80	65	5
CG.BN.M50S.BN.S.16.K01	M50	616 g	728 g	55	1.5 ... 29	1.5 ... 29	660.5	90	80	65	1
CG.BN.M50S.BN.S.16.K02	M50	616 g	1.66 kg	55	1.5 ... 29	1.5 ... 29	660.5	90	80	65	2
CG.BN.M50.BN.S.16.K01	M50	642 g	779 g	75	1.5 ... 37	1.5 ... 37	1075.2	90	90	75	1
CG.BN.M50.BN.S.16.K02	M50	642 g	1.76 kg	75	1.5 ... 37	1.5 ... 37	1075.2	90	90	75	2
CG.BN.M63S.BN.S.20.K01	M63	919 g	1.06 kg	75	1.5 ... 37	1.5 ... 37	1075.2	110	90	75	1
CG.BN.M63S.BN.S.20.K02	M63	919 g	2.31 kg	75	1.5 ... 37	1.5 ... 37	1075.2	110	90	75	2
CG.BN.M63.BN.S.20.K01	M63	1.72 kg	1.98 kg	99	1.5 ... 46	1.5 ... 46	1661.9	110	110	85	1
CG.BN.M63.BN.S.20.K02	M63	1.72 kg	4.17 kg	99	1.5 ... 46	1.5 ... 46	1661.9	110	110	85	2
CG.BN.M75S.BN.S.20.K01	M75	2 kg	2.26 kg	99	1.5 ... 46	1.5 ... 46	1661.9	110	110	85	1
CG.BN.M75S.BN.S.20.K02	M75	2 kg	4.72 kg	99	1.5 ... 46	1.5 ... 46	1661.9	110	110	85	2
CG.BN.M75.BN.S.20.K01	M75	3.26 kg	3.6 kg	129	1.5 ... 58	1.5 ... 58	2642.1	120	120	150	1
CG.BN.M75.BN.S.20.K02	M75	3.26 kg	7.4 kg	129	1.5 ... 58	1.5 ... 58	2642.1	120	120	150	2

*Knn: scope of delivery see table technical data

Dimensions Metric - Stainless Steel

Type	Thread size	Clamping range [mm]	Dimensions [mm]						
	TD	D	H	L	TL	D2	SW1	SW2	SW3
CG.BN.M20S.SS.S.16.*	M20	6 ... 13	49.2	65.2	16	27	25	25	25
CG.BN.M20.SS.S.16.*	M20	8 ... 15	49.2	65.2	16	27	25	25	25
CG.BN.M20L.SS.S.16.*	M20	13.5 ... 21	50.5	66.5	16	33	30	30	30
CG.BN.M25S.SS.S.16.*	M25	8 ... 15	49.2	65.2	16	33	30	25	25
CG.BN.M25.SS.S.16.*	M25	13.5 ... 21	50.5	66.5	16	33	30	30	30
CG.BN.M25L.SS.S.16.*	M25	18 ... 27	57.9	73.9	16	44.5	40	40	40
CG.BN.M32.SS.S.16.*	M32	18 ... 27	57.9	73.9	16	44.5	40	40	40
CG.BN.M32L.SS.S.16.*	M32	23 ... 33	59.7	75.7	16	47	43	43	43
CG.BN.M40S.SS.S.16.*	M40	23 ... 33	59.7	75.7	16	50	45	43	43
CG.BN.M40.SS.S.16.*	M40	29 ... 40	67.5	83.5	16	55.5	50	50	50
CG.BN.M50S.SS.S.16.*	M50	29 ... 40	67.5	83.5	16	61	55	50	50
CG.BN.M50.SS.S.16.*	M50	35 ... 48	73.2	89.2	16	64	58	58	58
CG.BN.M63S.SS.S.20.*	M63	35 ... 48	73.2	89.2	16	75	68	58	58
CG.BN.M63.SS.S.20.*	M63	42 ... 56	95.5	115.5	20	83	75	75	75
CG.BN.M75S.SS.S.20.*	M75	42 ... 56	95.5	115.5	20	89	80	75	75
CG.BN.M75.SS.S.20.*	M75	54 ... 70	104.5	124.5	20	110.5	100	100	100

Details and Accessories Metric - Stainless Steel

Type	Thread size	Mass approx.		Barrier details				Nut torques [Nm]			Delivery quantity
	TD	Component	Packaging unit	CQ max. qty.	DS [mm]	DM [mm]	CC max. [mm ²]	SW 1	SW 2	SW 3	
CG.BN.M20S.SS.S.16.K01	M20	145 g	202 g	9	1.5 ... 9.5	1.5 ... 9.5	70.9	60	60	30	1
CG.BN.M20S.SS.S.16.K15	M20	145 g	2.97 kg	9	1.5 ... 9.5	1.5 ... 9.5	70.9	60	60	30	15
CG.BN.M20.SS.S.16.K01	M20	139 g	196 g	9	1.5 ... 9.5	1.5 ... 9.5	70.9	60	60	25	1
CG.BN.M20.SS.S.16.K15	M20	139 g	2.89 kg	9	1.5 ... 9.5	1.5 ... 9.5	70.9	60	60	25	15
CG.BN.M20L.SS.S.16.K01	M20	176 g	233 g	9	1.5 ... 9.5	1.5 ... 9.5	70.9	60	60	35	1
CG.BN.M20L.SS.S.16.K15	M20	176 g	3.45 kg	9	1.5 ... 9.5	1.5 ... 9.5	70.9	60	60	35	15
CG.BN.M25S.SS.S.16.K01	M25	174 g	231 g	9	1.5 ... 9.5	1.5 ... 9.5	70.9	60	60	25	1
CG.BN.M25S.SS.S.16.K10	M25	174 g	2.36 kg	9	1.5 ... 9.5	1.5 ... 9.5	70.9	60	60	25	10
CG.BN.M25.SS.S.16.K01	M25	198 g	255 g	9	1.5 ... 9.5	1.5 ... 9.5	70.9	65	65	35	1
CG.BN.M25.SS.S.16.K10	M25	198 g	2.6 kg	9	1.5 ... 9.5	1.5 ... 9.5	70.9	65	65	35	10
CG.BN.M25L.SS.S.16.K01	M25	351 g	408 g	22	1.5 ... 15	1.5 ... 15	176.7	65	65	30	1
CG.BN.M25L.SS.S.16.K10	M25	351 g	4.13 kg	22	1.5 ... 15	1.5 ... 15	176.7	65	65	30	10
CG.BN.M32.SS.S.16.K01	M32	390 g	447 g	22	1.5 ... 15	1.5 ... 15	176.7	70	70	30	10
CG.BN.M32.SS.S.16.K10	M32	413 g	4.52 kg	22	1.5 ... 15	1.5 ... 15	176.7	70	70	30	10
CG.BN.M32L.SS.S.16.K01	M32	352 g	434 g	36	1.5 ... 21.5	1.5 ... 21.5	363.1	70	70	55	1
CG.BN.M32L.SS.S.16.K10	M32	352 g	4.39 kg	36	1.5 ... 21.5	1.5 ... 21.5	363.1	70	70	55	10
CG.BN.M40S.SS.S.16.K01	M40	416 g	503 g	36	1.5 ... 21.5	1.5 ... 21.5	363.1	80	70	55	1
CG.BN.M40S.SS.S.16.K05	M40	416 g	2.64 kg	36	1.5 ... 21.5	1.5 ... 21.5	363.1	80	70	55	5
CG.BN.M40.SS.S.16.K01	M40	469 g	581 g	55	1.5 ... 29	1.5 ... 29	660.5	80	80	65	1
CG.BN.M40.SS.S.16.K05	M40	469 g	3.03 kg	55	1.5 ... 29	1.5 ... 29	660.5	80	80	65	5
CG.BN.M50S.SS.S.16.K01	M50	582 g	694 g	55	1.5 ... 29	1.5 ... 29	660.5	90	80	65	1
CG.BN.M50S.SS.S.16.K02	M50	582 g	1.59 kg	55	1.5 ... 29	1.5 ... 29	660.5	90	80	65	2
CG.BN.M50.SS.S.16.K01	M50	606 g	743 g	75	1.5 ... 37	1.5 ... 37	1075.2	90	90	75	1
CG.BN.M50.SS.S.16.K02	M50	606 g	1.69 kg	75	1.5 ... 37	1.5 ... 37	1075.2	90	90	75	2
CG.BN.M63S.SS.S.20.K01	M63	868 g	1 kg	75	1.5 ... 37	1.5 ... 37	1075.2	110	90	75	1
CG.BN.M63S.SS.S.20.K02	M63	868 g	2.21 kg	75	1.5 ... 37	1.5 ... 37	1075.2	110	90	75	2
CG.BN.M63.SS.S.20.K01	M63	1.63 kg	1.89 kg	99	1.5 ... 46	1.5 ... 46	1661.9	110	110	85	1
CG.BN.M63.SS.S.20.K02	M63	1.63 kg	3.97 kg	99	1.5 ... 46	1.5 ... 46	1661.9	110	110	85	2
CG.BN.M75S.SS.S.20.K01	M75	1.89 kg	2.15 kg	99	1.5 ... 46	1.5 ... 46	1661.9	110	110	85	1
CG.BN.M75S.SS.S.20.K02	M75	1.89 kg	4.5 kg	99	1.5 ... 46	1.5 ... 46	1661.9	110	110	85	2
CG.BN.M75.SS.S.20.K01	M75	3.08 kg	3.42 kg	129	1.5 ... 58	1.5 ... 58	2642.1	120	120	150	1
CG.BN.M75.SS.S.20.K02	M75	3.08 kg	7.04 kg	129	1.5 ... 58	1.5 ... 58	2642.1	120	120	150	2

*Knn: scope of delivery see table technical data

Dimensions NPT - Brass Nickel-plated

Type	Thread size	Clamping range [mm]	Dimensions [mm]						
	TD	D	H	L	TL	D2	SW1	SW2	SW3
CG.BN.NPT1/2S.BN.S.21.*	NPT 1/2"	6 ... 13	49.2	70.2	21	27	25	25	25
CG.BN.NPT1/2.BN.S.21.*	NPT 1/2"	8 ... 15	49.2	70.2	21	27	25	25	25
CG.BN.NPT1/2L.BN.S.21.*	NPT 1/2"	13.5 ... 21	50.5	71.5	21	33	30	30	30
CG.BN.NPT3/4S.BN.S.21.*	NPT 3/4"	8 ... 15	49	70	21	33	30	25	25
CG.BN.NPT3/4.BN.S.21.*	NPT 3/4"	13.5 ... 21	50.5	71.5	21	33	30	30	30
CG.BN.NPT3/4L.BN.S.21.*	NPT 3/4"	18 ... 27	58	79	21	44.5	40	40	40
CG.BN.NPT1.BN.S.26.*	NPT 1"	18 ... 27	57.9	83.9	26	44.5	40	40	40
CG.BN.NPT1L.BN.S.26.*	NPT 1"	23 ... 33	59.7	85.7	26	47	43	43	43
CG.BN.NPT1-1/4S.BN.S.28.*	NPT 1-1/4"	23 ... 33	59.7	87.7	28	50	45	43	43
CG.BN.NPT1-1/4.BN.S.28.*	NPT 1-1/4"	29 ... 40	67.5	95.5	28	55.5	50	50	50
CG.BN.NPT1-1/2.BN.S.28.*	NPT 1-1/2"	29 ... 40	67.3	95.3	28	61	55	50	50
CG.BN.NPT2.BN.S.28.*	NPT 2"	35 ... 48	73.2	101.2	28	72	65	58	58
CG.BN.NPT2-1/2.BN.S.41.*	NPT 2-1/2"	42 ... 56	95.9	136.9	41	89	80	75	75
CG.BN.NPT3.BN.S.43.*	NPT 3"	54 ... 70	104.5	147.5	43	110.5	100	100	100

Details and Accessories NPT - Brass Nickel-plated

Type	Thread size	Mass approx.		Barrier details				Nut torques [Nm]			Delivery quantity
	TD	Component	Packaging unit	CQ max. qty.	DS [mm]	DM [mm]	CC max. [mm ²]	SW 1	SW 2	SW 3	
CG.BN.NPT1/2S.BN.S.21.K01	NPT 1/2"	170 g	227 g	9	1.5 ... 9.5	1.5 ... 9.5	70.9	60	60	30	1
CG.BN.NPT1/2S.BN.S.21.K15	NPT 1/2"	170 g	3.36 kg	9	1.5 ... 9.5	1.5 ... 9.5	70.9	60	60	30	15
CG.BN.NPT1/2.BN.S.21.K01	NPT 1/2"	164 g	221 g	9	1.5 ... 9.5	1.5 ... 9.5	70.9	60	60	25	1
CG.BN.NPT1/2.BN.S.21.K15	NPT 1/2"	164 g	3.27 kg	9	1.5 ... 9.5	1.5 ... 9.5	70.9	60	60	25	15
CG.BN.NPT1/2L.BN.S.21.K01	NPT 1/2"	202 g	259 g	9	1.5 ... 9.5	1.5 ... 9.5	70.9	60	60	35	1
CG.BN.NPT1/2L.BN.S.21.K15	NPT 1/2"	202 g	3.84 kg	9	1.5 ... 9.5	1.5 ... 9.5	70.9	60	60	35	15
CG.BN.NPT3/4S.BN.S.21.K01	NPT 3/4"	213 g	270 g	9	1.5 ... 9.5	1.5 ... 9.5	70.9	60	60	25	1
CG.BN.NPT3/4S.BN.S.21.K10	NPT 3/4"	213 g	2.75 kg	9	1.5 ... 9.5	1.5 ... 9.5	70.9	60	60	25	10
CG.BN.NPT3/4.BN.S.21.K01	NPT 3/4"	237 g	294 g	9	1.5 ... 9.5	1.5 ... 9.5	70.9	65	65	35	1
CG.BN.NPT3/4.BN.S.21.K10	NPT 3/4"	237 g	2.99 kg	9	1.5 ... 9.5	1.5 ... 9.5	70.9	65	65	35	10
CG.BN.NPT3/4L.BN.S.21.K01	NPT 3/4"	394 g	451 g	22	1.5 ... 15	1.5 ... 15	176.7	65	65	30	1
CG.BN.NPT3/4L.BN.S.21.K10	NPT 3/4"	394 g	4.56 kg	22	1.5 ... 15	1.5 ... 15	176.7	65	65	30	10
CG.BN.NPT1.BN.S.26.K01	NPT 1"	476 g	538 g	22	1.5 ... 15	1.5 ... 15	176.7	70	70	30	1
CG.BN.NPT1.BN.S.26.K10	NPT 1"	476 g	5.38 kg	22	1.5 ... 15	1.5 ... 15	176.7	70	70	30	10
CG.BN.NPT1L.BN.S.26.K01	NPT 1"	420 g	507 g	36	1.5 ... 21.5	1.5 ... 21.5	363.1	70	70	55	1
CG.BN.NPT1L.BN.S.26.K10	NPT 1"	420 g	5.07 kg	36	1.5 ... 21.5	1.5 ... 21.5	363.1	70	70	55	10
CG.BN.NPT1-1/4S.BN.S.28.K01	NPT 1-1/4"	556 g	643 g	36	1.5 ... 21.5	1.5 ... 21.5	363.1	70	70	55	1
CG.BN.NPT1-1/4S.BN.S.28.K05	NPT 1-1/4"	556 g	3.34 kg	36	1.5 ... 21.5	1.5 ... 21.5	363.1	70	70	55	5
CG.BN.NPT1-1/4.BN.S.28.K01	NPT 1-1/4"	577 g	689 g	55	1.5 ... 29	1.5 ... 29	660.5	80	80	65	1
CG.BN.NPT1-1/4.BN.S.28.K05	NPT 1-1/4"	577 g	3.57 kg	55	1.5 ... 29	1.5 ... 29	660.5	80	80	65	5
CG.BN.NPT1-1/2.BN.S.28.K01	NPT 1-1/2"	703 g	815 g	55	1.5 ... 29	1.5 ... 29	660.5	80	80	65	1
CG.BN.NPT1-1/2.BN.S.28.K02	NPT 1-1/2"	703 g	1.83 kg	55	1.5 ... 29	1.5 ... 29	660.5	80	80	65	2
CG.BN.NPT2.BN.S.28.K01	NPT 2"	970 g	1.11 kg	75	1.5 ... 37	1.5 ... 37	1075.2	90	90	75	1
CG.BN.NPT2.BN.S.28.K02	NPT 2"	917 g	2.42 kg	75	1.5 ... 37	1.5 ... 37	1075.2	90	90	75	2
CG.BN.NPT2-1/2.BN.S.41.K01	NPT 2-1/2"	2.36 kg	2.62 kg	99	1.5 ... 46	1.5 ... 46	1661.9	110	110	85	1
CG.BN.NPT2-1/2.BN.S.41.K02	NPT 2-1/2"	2.36 kg	5.45 kg	99	1.5 ... 46	1.5 ... 46	1661.9	110	110	85	2
CG.BN.NPT3.BN.S.43.K01	NPT 3"	4.14 kg	4.47 kg	129	1.5 ... 58	1.5 ... 58	2642.1	120	120	150	1
CG.BN.NPT3.BN.S.43.K02	NPT 3"	4.14 kg	9.15 kg	129	1.5 ... 58	1.5 ... 58	2642.1	120	120	150	2

*Knn: scope of delivery see table technical data

Dimensions NPT - Stainless Steel

Type	Thread size	Clamping range [mm]	Dimensions [mm]						
	TD	D	H	L	TL	D2	SW1	SW2	SW3
CG.BN.NPT1/2S.SS.S.21.*	NPT 1/2"	6 ... 13	49.2	70.2	21	27	25	25	25
CG.BN.NPT1/2.SS.S.21.*	NPT 1/2"	8 ... 15	49.2	70.2	21	27	25	25	25
CG.BN.NPT1/2L.SS.S.21.*	NPT 1/2"	13.5 ... 21	50.5	71.5	21	33	30	30	30
CG.BN.NPT3/4S.SS.S.21.*	NPT 3/4"	8 ... 15	49	70	21	33	30	25	25
CG.BN.NPT3/4.SS.S.21.*	NPT 3/4"	13.5 ... 21	50.5	71.5	21	33	30	30	30
CG.BN.NPT3/4L.SS.S.21.*	NPT 3/4"	18 ... 27	58	79	21	44.5	40	40	40
CG.BN.NPT1.SS.S.26.*	NPT 1"	18 ... 27	57.9	83.9	26	44.5	40	40	40
CG.BN.NPT1L.SS.S.26.*	NPT 1"	23 ... 33	59.7	85.7	26	47	43	43	43
CG.BN.NPT1-1/4S.SS.S.28.*	NPT 1-1/4"	23 ... 33	59.7	87.7	28	50	45	43	43
CG.BN.NPT1-1/4.SS.S.28.*	NPT 1-1/4"	29 ... 40	67.5	95.5	28	55.5	50	50	50
CG.BN.NPT1-1/2.SS.S.28.*	NPT 1-1/2"	29 ... 40	67.3	95.3	28	61	55	50	50
CG.BN.NPT2.SS.S.28.*	NPT 2"	35 ... 48	73.2	101.2	28	72	65	58	58
CG.BN.NPT2-1/2.SS.S.41.*	NPT 2-1/2"	42 ... 56	95.9	136.9	41	89	80	75	75
CG.BN.NPT3.SS.S.43.*	NPT 3"	54 ... 70	104.5	147.5	43	110.5	100	100	100

Details and Accessories NPT - Stainless Steel

Type	Thread size	Mass approx.		Barrier details				Nut torques [Nm]			Delivery quantity
	TD	Component	Packaging unit	CQ max. qty.	DS [mm]	DM [mm]	CC max. [mm ²]	SW 1	SW 2	SW 3	
CG.BN.NPT1/2S.SS.S.21.K01	NPT 1/2"	161 g	218 g	9	1.5 ... 9.5	1.5 ... 9.5	70.9	60	60	30	1
CG.BN.NPT1/2S.SS.S.21.K15	NPT 1/2"	161 g	3.22 kg	9	1.5 ... 9.5	1.5 ... 9.5	70.9	60	60	30	15
CG.BN.NPT1/2.SS.S.21.K01	NPT 1/2"	155 g	212 g	9	1.5 ... 9.5	1.5 ... 9.5	70.9	60	60	25	1
CG.BN.NPT1/2.SS.S.21.K15	NPT 1/2"	155 g	3.13 kg	9	1.5 ... 9.5	1.5 ... 9.5	70.9	60	60	25	15
CG.BN.NPT1/2L.SS.S.21.K01	NPT 1/2"	191 g	248 g	9	1.5 ... 9.5	1.5 ... 9.5	70.9	60	60	35	1
CG.BN.NPT1/2L.SS.S.21.K15	NPT 1/2"	191 g	3.67 kg	9	1.5 ... 9.5	1.5 ... 9.5	70.9	60	60	35	15
CG.BN.NPT3/4S.SS.S.21.K01	NPT 3/4"	202 g	259 g	9	1.5 ... 9.5	1.5 ... 9.5	70.9	60	60	25	1
CG.BN.NPT3/4S.SS.S.21.K10	NPT 3/4"	202 g	3.64 kg	9	1.5 ... 9.5	1.5 ... 9.5	70.9	60	60	25	10
CG.BN.NPT3/4.SS.S.21.K01	NPT 3/4"	224 g	281 g	9	1.5 ... 9.5	1.5 ... 9.5	70.9	65	65	35	1
CG.BN.NPT3/4.SS.S.21.K10	NPT 3/4"	224 g	2.86 kg	9	1.5 ... 9.5	1.5 ... 9.5	70.9	65	65	35	10
CG.BN.NPT3/4L.SS.S.21.K01	NPT 3/4"	373 g	430 g	22	1.5 ... 15	1.5 ... 15	176.7	65	65	30	1
CG.BN.NPT3/4L.SS.S.21.K10	NPT 3/4"	373 g	4.35 kg	22	1.5 ... 15	1.5 ... 15	176.7	65	65	30	10
CG.BN.NPT1.SS.S.26.K01	NPT 1"	450 g	512 g	22	1.5 ... 15	1.5 ... 15	176.7	70	70	30	1
CG.BN.NPT1.SS.S.26.K10	NPT 1"	450 g	5.12 kg	22	1.5 ... 15	1.5 ... 15	176.7	70	70	30	10
CG.BN.NPT1L.SS.S.26.K01	NPT 1"	396 g	483 g	36	1.5 ... 21.5	1.5 ... 21.5	363.1	70	70	55	1
CG.BN.NPT1L.SS.S.26.K10	NPT 1"	396 g	4.83 kg	36	1.5 ... 21.5	1.5 ... 21.5	363.1	70	70	55	10
CG.BN.NPT1-1/4S.SS.S.28.K01	NPT 1-1/4"	525 g	612 g	36	1.5 ... 21.5	1.5 ... 21.5	363.1	70	70	55	1
CG.BN.NPT1-1/4S.SS.S.28.K05	NPT 1-1/4"	525 g	3.19 kg	36	1.5 ... 21.5	1.5 ... 21.5	363.1	70	70	55	5
CG.BN.NPT1-1/4.SS.S.28.K01	NPT 1-1/4"	545 g	657 g	55	1.5 ... 29	1.5 ... 29	660.5	80	80	65	1
CG.BN.NPT1-1/4.SS.S.28.K05	NPT 1-1/4"	545 g	3.41 kg	55	1.5 ... 29	1.5 ... 29	660.5	80	80	65	5
CG.BN.NPT1-1/2.SS.S.28.K01	NPT 1-1/2"	664 g	776 g	55	1.5 ... 29	1.5 ... 29	660.5	80	80	65	1
CG.BN.NPT1-1/2.SS.S.28.K02	NPT 1-1/2"	664 g	1.75 kg	55	1.5 ... 29	1.5 ... 29	660.5	80	80	65	2
CG.BN.NPT2.SS.S.28.K01	NPT 2"	917 g	1.05 kg	75	1.5 ... 37	1.5 ... 37	1075.2	90	90	75	1
CG.BN.NPT2.SS.S.28.K02	NPT 2"	917 g	2.31 kg	75	1.5 ... 37	1.5 ... 37	1075.2	90	90	75	2
CG.BN.NPT2-1/2.SS.S.41.K01	NPT 2-1/2"	2.23 kg	2.49 kg	99	1.5 ... 46	1.5 ... 46	1661.9	110	110	85	1
CG.BN.NPT2-1/2.SS.S.41.K02	NPT 2-1/2"	2.23 kg	5.18 kg	99	1.5 ... 46	1.5 ... 46	1661.9	110	110	85	2
CG.BN.NPT3.SS.S.43.K01	NPT 3"	3.9 kg	4.24 kg	129	1.5 ... 58	1.5 ... 58	2642.1	120	120	150	1
CG.BN.NPT3.SS.S.43.K02	NPT 3"	3.9 kg	8.69 kg	129	1.5 ... 58	1.5 ... 58	2642.1	120	120	150	2

*Knn: scope of delivery see table technical data